

**MacDon** *Performance Parts*



***Draper Headers***

Sickle Sections

FITS

All MacDon Draper Headers\*, Case 2142/2152/2162, New Holland 82C/83C/86C, JD 400D Series

**PART #** See Tables

DESCRIPTION

MacDon Austempered Sickle Sections undergo a unique heat treatment process to provide a tougher, and more impact resistant structure, for maximum strength and wear characteristics! Can be used in any harvest situation, designed and engineered to perform better than standard sickle sections.

Busatis Sickle Sections (non-Austempered option) are also available for 1-Series and older headers. They are a more economical version when compared against our factory standard Austempered sections.

FEATURES/BENEFITS

- » Designed to self sharpen as they wear, meaning your sickle sections will continue to stay sharp throughout the section life
- » Guaranteed hole spacing means your replacement sickle section will fit your MacDon perfectly every time, inconsistently spaced holes lead to premature bolt failure costing valuable downtime

AUSTEMPERED SICKLE SECTIONS

PART #	DESCRIPTION
279641	COARSE SECTION (25 PK)
279642	FINE SECTION (25 PK)
294947	ULTRA COARSE SECTION (25 PK)
279310	COARSE BOTTOM COUNTER SUNK SECTION (10 PK)
279312	FINE BOTTOM COUNTER SUNK SECTION (10 PK)
279314	CHAMFERED COARSE TOP COUNTER SUNK SECTION (10 PK)
279316	CHAMFERED FINE TOP COUNTER SUNK SECTION (10 PK)

BUSATIS SICKLE SECTIONS

PART #	DESCRIPTION
174845	COARSE BUSATIS SECTION (25 PK)
118491	FINE BUSATIS SECTION (25 PK)
279999	COARSE TOP COUNTER SUNK BUSATIS SECTION (10 PK)
279848	FINE TOP COUNTER SUNK BUSATIS SECTION (10 PK)
279851	COARSE BOTTOM COUNTER SUNK BUSATIS SECTION (10 PK)
279850	FINE BOTTOM COUNTER SUNK BUSATIS SECTION (10 PK)

Notes:

\* Exclude FD2/D2 Series Draper Headers

AUSTEMPERED  
ULTRA-COARSE SECTION



For thicker stemmed crops and adverse soybean conditions

AUSTEMPERED  
FINE SECTION



For forage, grasses and thin stemmed crops like flax and lentils

AUSTEMPERED  
COARSE SECTION



For cereals, canola, pulses and soybeans

BUSATIS  
COARSE SECTION



For cereals, canola, pulses and soybeans

## Knife Assembly Kits

### FITS

All D and FD Series\*, Case 2142/2152/2162, New Holland 82C/83C/86C, JD 400D Series

### DESCRIPTION

Provides all necessary knife segments and splice kits required to replace the complete knife on a header.

### FEATURES/BENEFITS

» Convenient package for ease of transportation

### KNIFE ASSEMBLY KITS - SINGLE KNIFE

DESCRIPTION	PART #			MACDON MODELS
	COARSE	FINE	ULTRA-COARSE	
20 FT, SK	-	335488	-	D50, D60, D65, D1
25 FT, SK	-	335489	335513	D50, D60, D65, D1, FD1
30 FT, SK	294795	335490	335514	D50, D60, FD70, D65, FD75, D1, D1XL, FD1
35 FT, SK	294796	335491	335515	
40 FT, SK	294797	335492	335516	

### KNIFE ASSEMBLY KITS - DOUBLE KNIFE

DESCRIPTION	PART #			MACDON MODELS
	COARSE	FINE	ULTRA-COARSE	
20 FT, DK	-	335479	-	D50, D60, D65, D1
25 FT, DK	-	335483	335508	
30 FT, DK	294791	335484	335509	D50, D60, D65, D1, D1XL
35 FT, DK	294792	335485	335510	
40 FT, DK	294793	335486	335511	D50, D60, FD70, D65, FD75, D1, D1XL, FD1
45 FT, DK	294794	335487	335512	

#### Notes:

\*Knife Heads not included

^Exclude FD2/D2 Series Draper Headers

## Knife Splice/Repair Kit

### FITS

All D and FD Series\*, Case 2142/2152/2162, New Holland 82C/83C/86C, JD 400D Series

### PART # 129043

### DESCRIPTION

Splice kit to repair broken knife.

### FEATURES/BENEFITS

- » Provide a quick repair for broken sickles
- » Durable connection, the same used for splicing segmented knives together

#### Notes:

\*Exclude FD2/D2 Series Draper Headers



## Knife Head

### FITS

All D and FD Series\*, Case 2142/2152/2162, New Holland 82C/83C/86C, JD 400D Series

### PART # See Table

### DESCRIPTION

Use this quick and easy guide for reference when replacing MacDon knife heads.

MACDON MODELS	CONFIGURATION	PART #
FD1, FD75, FD70	SK	1 x 132896
	DK	1 x 132896 (LH) 1 x 132897 (RH)
D50, D60, D65, D1	SK20/25	1 x 120832
	SK30/35	1 x 132896
	DK15/20/25	2 x 120832
	DK30 >	1 x 132896 (LH) 1 x 132897 (RH)

#### Notes:

\*Exclude FD2/D2 Series Draper Headers



Center Overlap Kit

FITS

All Double Knife Draper Headers\*, Case 2142/2152/2162, New Holland 82C/83C/86C, JD 400D Series

**PART #** 279996 (Fine sickle sections), 279997 (Coarse sickle sections), or 335326 (Ultra Coarse sickle section)

DESCRIPTION

Contains all special countersunk sections and hardware for the center knife overlap on Double Knife Drive Headers.

FEATURES/BENEFITS

- » Eliminates left over sections from buying the larger 10 packs

Notes:

\*Exclude FD2/D2 Series Draper Headers

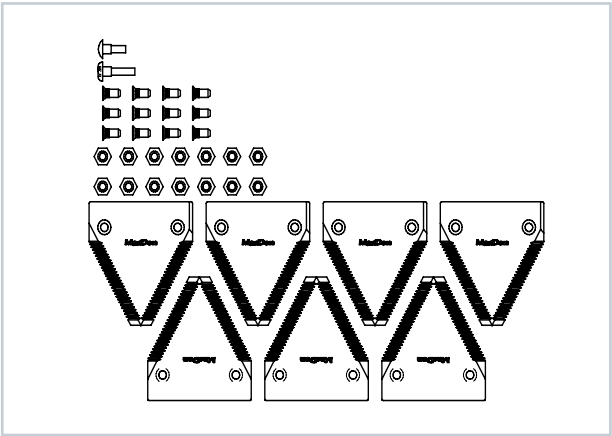

Crop Lifters

FITS

All MacDon Draper Headers\*, Case 2142/2152/2162, New Holland 82C/83C/86C, JD 400D Series

**PART #** 255929\* *\*Installation hardware must be ordered separately.*

DESCRIPTION

Attach to the cutterbar and are designed to lift lodged crop.

FEATURES/BENEFITS

- » Designed specifically by MacDon for MacDon machines, offering a custom header fit providing optimal functionality through all tilt angles
- » Custom fit to MacDon guards to minimize movement during cutting and prevent loss of lifters
- » Curved contact point allows lifter to glide along the ground without digging or getting knocked off

PART #	DESCRIPTION	MACDON MODELS
255929	CROP LIFTER	D50, D60, D65, FD70, FD75, D1, FD1
279575	BOLT 2.5 INCH	-
21761	NUT	-
255930	WASHER	-
255927	COUPLING NUT 20MM	-
255928	COUPLING NUT 10MM	-

Notes:

\*Select one suitable coupling nut option. Combines with tracks require Part #255927. Combines with standard tires require Part #255928.  
\*Exclude FD2/D2 Series Draper Headers

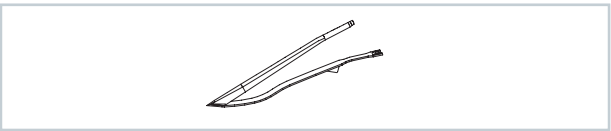

Crop Lifter Storage Rack

FITS

FD/D Series Headers\*, Case 2162/2152/2142 headers, JD 400D Series

**KIT #** B6376 (FD75/D65/D1/FD1), B5408 (FD70/D50/D60, Case 2162/2152/2142)

DESCRIPTION

Storage rack which attaches to the back of the header. Bundle comes with two racks, one for each side.

FEATURES/BENEFITS

- » Convenient storage location for crop lifters while they are not in use
- » Easily installs on the header back tube

Notes:

\*Exclude FD2/D2 Series Draper Headers

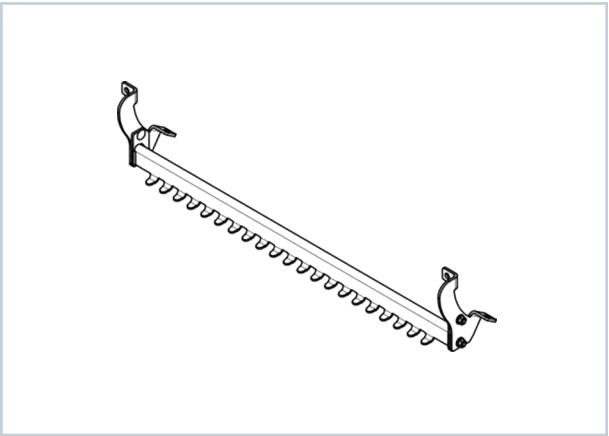

Guards

FITS

All MacDon Draper Headers\*, Case 2142/2152/2162, New Holland 82C/83C/86C, JD 400D Series

**PART #** See Tables

DESCRIPTION

All MacDon guards are fully thru-hardened for toughness, then induction hardened in key high wear areas so they will keep their cutting edge longer. Single heat treated guards only recommended for use in conditions where guards break before they wear out.

FEATURES/BENEFITS

- » Cutting surface is induction hardened providing targeted hardening in high contact areas, resulting in a superior cutting performance
- » Critical dimensions ensure a perfect fit on your MacDon machine every time, allowing for minimal downtime and quick replacements
- » Tapered edge design allows for sickle sections to be replaced without removing guard

Notes:

*\*Exclude FD2/D2 Series Draper Headers*

POINTED GUARD

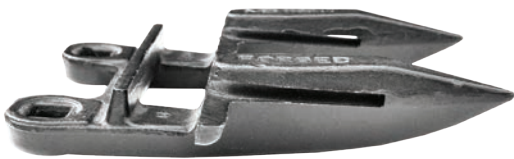

STUB BOTTOM GUARD



SHEET METAL TOP



FORGED METAL TOP



POINTED GUARDS

PART #	DESCRIPTION
118344	DOUBLE HEAT TREATED POINTED GUARD
118484	SINGLE HEAT TREATED POINTED GUARD
118301	LEFT HAND END GUARD
118302	RIGHT HAND END GUARD
118345	NO KNIFE LEDGERS (FOR DRIVE END)

STUB GUARDS

PART #	DESCRIPTION
34359	DOUBLE HEAT TREATED TOP STUB GUARD
118346	DOUBLE HEAT TREATED BOTTOM STUB GUARD
135586	SINGLE HEAT TREATED TOP STUB GUARD
135575	SINGLE HEAT TREATED BOTTOM STUB GUARD
118351	SHEET METAL TOP STUB GUARD

Recommended Cutting Components Combinations



**Pointed Guard  
Recommended**  
» For rocky conditions  
» On ground applications



**Stub Guard  
Recommended**  
» For off ground application  
» Tough cutting conditions



## Guard Kits

### FITS

All D and FD Series\*, Case 2142/2152/2162, New Holland 82C/83C/86C, JD 400D Series

**PART #** See Tables

### DESCRIPTION

Kit includes all guards required to do a complete cutterbar replacement.

### FEATURES/BENEFITS

» Convenient kits, ensure customers get all guards needed for a cutterbar rebuild.

### GUARD KITS - SINGLE KNIFE

PART #	DESCRIPTION	MACDON MODELS
304990	KIT - POINTED GUARDS FOR 25 FOOT, SINGLE KNIFE	D60, D65, D1, FD1
304991	KIT - POINTED GUARDS FOR 30 FOOT, SINGLE KNIFE	D50, D60, D65, FD70, FD75, D1, FD1
304992	KIT - POINTED GUARDS FOR 35 FOOT, SINGLE KNIFE	-
304993	KIT - POINTED GUARDS FOR 40 FOOT, SINGLE KNIFE	-

### GUARD KITS - DOUBLE KNIFE

PART #	DESCRIPTION	MACDON MODELS
304986	KIT - POINTED GUARDS FOR 30 FOOT, DOUBLE KNIFE	D50, D60, D65, FD70, FD75, D1, FD1
304987	KIT - POINTED GUARDS FOR 35 FOOT, DOUBLE KNIFE	-
304988	KIT - POINTED GUARDS FOR 40 FOOT, DOUBLE KNIFE	-
304989	KIT - POINTED GUARDS FOR 45 FOOT, DOUBLE KNIFE	-

### Notes:

\*Hardware sold separately. ^Exclude FD2/D2 Series Draper Headers

## Know when to replace guards and sickle sections



The guards and sickle sections of a MacDon header work together to cut crops and when worn, need to be replaced together to ensure optimal performance. Sickle sections are designed to wear back keeping their original shape, but wearing into a finer point that increases the distance between the two cutting surfaces. Sickle sections also develop wear grooves on top of the section from repeatedly dragging the crop between the section and the guard. Guards develop a round and smooth lower cutting edge, increasing the gap that the knife passes through. When this occurs they are ready to be replaced. Proper cutting component maintenance is critical for reliable and efficient header operation.

A clean cut promotes fast crop regrowth while a ragged cut slows regrowth. When your guards and sickle section cutting edges wear down, crop begins to pinch and rip, decreasing efficiency and increasing demand on horsepower.

## Sickle section and guard replacement guide

Use these diagrams to assess the wear on your parts. Just place it on top of the diagram to determine if the part needs replacing.

 **New**  
 **Needs replacement**

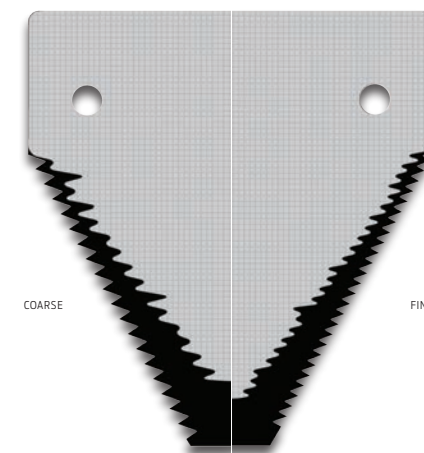
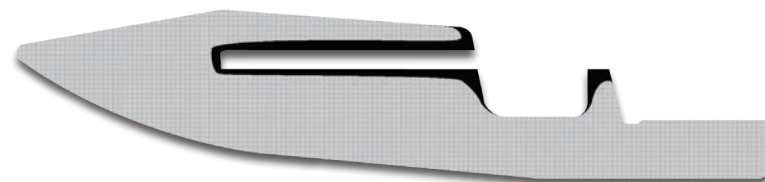

Guards and Sections work together like the blades on a pair of scissors with hold downs acting as the bolt holding them together. It is important to change out both section and guard as they wear as they are both crucial cutting components.

Side Draper Belts

FITS

All D and FD Series\*, Case 2142/2152/2162,  
New Holland 82C/83C/86C, JD 400D Series

PART # See Table

DESCRIPTION

The only draper belts that come with exclusive double V-guide and cutterbar seal technology, for better tracking and minimal seed loss.

FEATURES/BENEFITS

- » Square and Taper cleat options available
- » Double V-Guide allows for fully reversible drapers, doubling draper life
- » Exclusive cutterbar seal prevents seed loss at leading edge of draper
- » Metal slat connectors provide increased durability and an optimal connection for longer lasting drapers
- » MacDon branded for authenticity

SIZE	TAPERED CLEAT	SQUARE CLEAT	D1 XL* (50" DEEP)
15 FT	220634	172192	-
20 FT	220635	-	-
25 FT	220636	-	-
30 FT	220637	172195	227750
35 FT	220638	172196	227751
40 FT	220639	172197	227752
45 FT	220640	172198	227753
150 FT BULK ROLL	220642	-	-

\*Only Taper cleat option available

Notes:

\*Exclude FD2/D2 Series Draper Headers

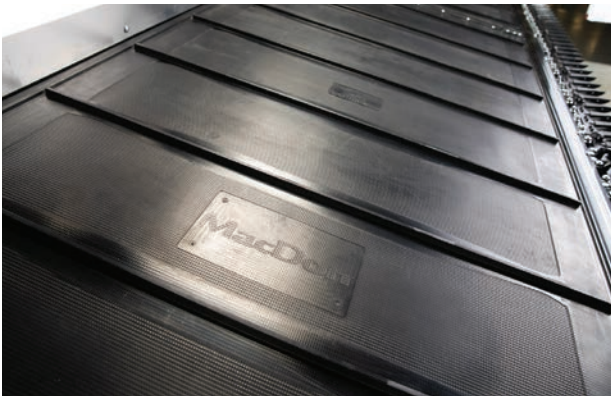

TAPER CLEAT SIDE DRAPER BELT

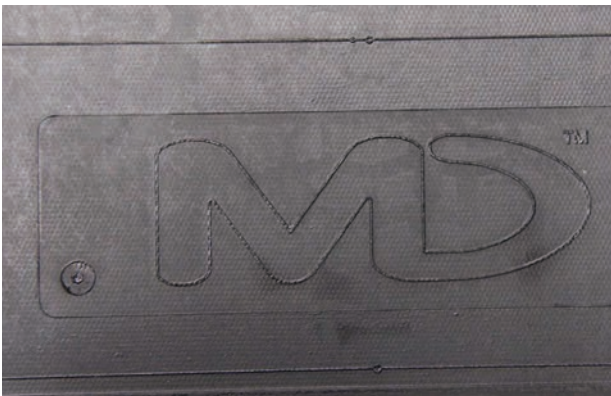

SQUARE CLEAT SIDE DRAPER BELT

Feed Draper Belt

FITS

All D and FD Series\*, Case 2142/2152/2162,  
New Holland 82C/83C/86C

PART # 304454

DESCRIPTION

Feed Draper Belt replaces 133131, 287896, 295934.

FEATURES/BENEFITS

- » Increased material thickness for improved durability
- » Improved tapered cleat design for increased life and durability

Notes:

\*Exclude FD2/D2 Series Draper Headers



Old Feed Draper Cleat



New Feed Draper Cleat

## Draper Clips

### FITS

FD/D Series Headers\*, Case 2162/2152/2142 headers,  
New Holland 82C/83C/86C, JD 400D Series

**PART #** 294858 (Taper cleat), 294859 (Square cleat)

### DESCRIPTION

MacDon's patented Draper Clips are protective clips that are designed to extend the life of draper belts in abrasive or high wear conditions. Simply snap the Draper Clip into place over top the damaged draper cleat and tap with a mallet in order to ensure secure installation.

### FEATURES/BENEFITS

- » Clips right on the cleats of your MacDon draper belt
- » Provides a hard, low friction covering at a fraction of the price of replacing the entire draper belt
- » Can extend the service life of the draper belt in abrasive or high wear conditions
- » Most beneficial in very hot/sandy conditions or where draper belts experience high loads, such as swathing heavy canola

#### Notes:

\*Exclude FD2/D2 Series Draper Headers

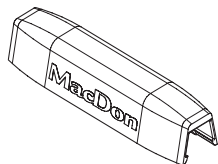

**TAPER CLEAT  
DRAPER CLIP**

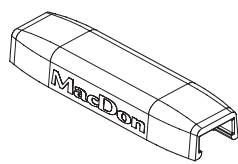

**SQUARE CLEAT  
DRAPER CLIP**

## Draper Repair Kit

### FITS

All D and FD Series\*, Case 2142/2152/2162,  
New Holland 82C/83C/86C

**KIT #** 220641, 253572 (D1 XL)

### DESCRIPTION

20 inch section of draper to fix damaged draper. Includes two sets of connector slats 132777.

### FEATURES/BENEFITS

- » Low cost alternative to replacing entire draper
- » Simply cut out damaged section and splice in repair section with the included hardware

#### Notes:

\*Exclude FD2/D2 Series Draper Headers

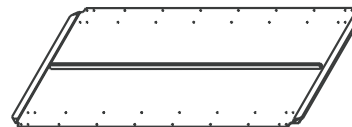

## Draper Slat Connector Kit

### FITS

All D and FD Series\*, Case 2142/2152/2162,  
New Holland 82C/83C/86C, JD 400D Series

**KIT #** 132777, 253134 (D1 XL)

### DESCRIPTION

Replacement hardware kit for attaching side drapers together.

### FEATURES/BENEFITS

- » High quality steel slats and hardware to ensure your drapers stay connected
- » Includes all necessary parts for connecting side drapers

#### Notes:

\*Exclude FD2/D2 Series Draper Headers

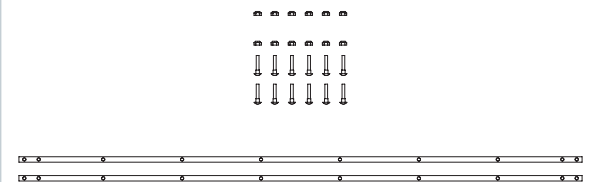



## Front Track Hinge Kit

### FITS

FD75, FD70's & Case 2162

**PART #** 220196

### DESCRIPTION

Kit adds a hinge to the draper deck of the header flex point.

### FEATURES/BENEFITS

- » Improves durability of draper deck
- » Extends life of side drapers
- » Upgrades to latest FD75 specs

#### Notes:

*\*This kit contains enough pieces to do both sides. Some cutting and welding is required.*



## In Cab Side Draper Speed Control

### FITS

FD1/D1

**KIT #** B6701 (John Deere), B6702 (CNH), B6703 (Generic)

### DESCRIPTION

Optional kit to allow operators to adjust draper speed from the combine cab.

### FEATURES/BENEFITS

- » In cab on the go adjustability of the side drapers
- » Allows user to optimize draper speeds based on condition
- » Allows for controlled feeding when dealing with a plugged feederhouse

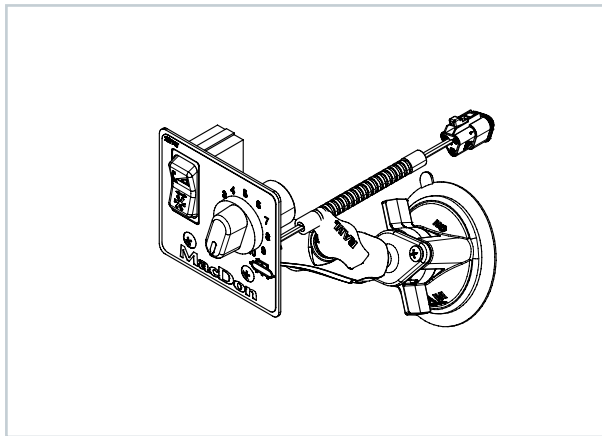

## Tungsten-Carbide Draper Drive Rollers\*

### FITS

All D and FD Series\*, Case 2142/2152/2162, New Holland 82C/83C/86C, JD 400D Series

**PART #** 255410 (x2)

### DESCRIPTION

Draper drive rollers with tungsten-carbide ribs.

### FEATURES/BENEFITS

- » Eliminate side draper slipping in wet, oily conditions
- » Tungsten-Carbide ribs provide superior grip on drapers compared to rubber coated rollers

#### Notes:

*\*Come Standard on D65 headers 2015 model year and up.  
^Exclude FD2/D2 Series Draper Headers*



## Keep your MacDon at peak performance with MacDon Draper Header Service Kits

Order Draper Header Service Kits from MacDon for one convenient package containing high wear draper header replacement parts required for your machine.

Select from the options below to find your MacDon Draper Header Service Kit.



\*Note: 279097 pictured above

### DRAPER HEADER SERVICE KIT

FD75/D65/CA25

#### 279097

- 129297 - Wearplates (5)
- 118344 - Guards (5)
- 174849 - Reel Fingers (10)
- 279641 - Coarse Section (25)
- 220938 - Finger Assemblies (5)
- 320360 - Hydraulic Filter Kit (1)
- 135626 - Section Nuts (50)
- 135632 - Long Section Screws (50)
- 135628 - Short Section Screws (50)

### DRAPER HEADER SERVICE KIT

FD1/D1/FM100

#### 335353

- 129297 - Wearplates (5)
- 118344 - Guards (4)
- 118345 - Guards (1)
- 279641 - Coarse Section (25)
- 337152 - Feed Auger Finger Kit (1)
- 320360 - Hydraulic Filter Kit (1)
- 120558 - Guard Bolts (10)
- 18654 - Guard Nuts (10)
- 52417 - Long Knife Head Bolts & Nuts (25)
- 52413 - Standard Section Bolts & Nuts (50)

### COARSE SECTION SERVICE KIT

D65/D1 X/D1 XL

#### 279100

- 129297 - Wearplates (5)
- 118344 - Guards (5)
- 174849 - Reel Fingers (10)
- 279641 - Coarse Section (25)
- 135626 - Section Nuts (50)
- 135632 - Long Section Screws (50)
- 135628 - Short Section Screws (50)

### FINE SECTION SERVICE KIT

D65/D1 X/D1 XL

#### 279099

- 129297 - Wearplates (5)
- 118344 - Guards (5)
- 174849 - Reel Fingers (10)
- 279642 - Fine Section (25)
- 135626 - Section Nuts (50)
- 135632 - Long Section Screws (50)
- 135628 - Short Section Screws (50)

## Anti-Wrapping Kit

### FITS

FD75 (double reel), FD70, D65 & Case 2162

**KIT #** See Tables

### DESCRIPTION

Reel end shields and plastic fingers for end of reel.

### FEATURES/BENEFITS

- » Prevents canola and other green crop from getting caught in coils of steel fingers at center of double reel headers
- » Replaces steel coil fingers with plastic and adds reel end shields to improve feeding at center of double reel

#### Notes:

*\*Helpful in green canola but not recommended in soybeans.*

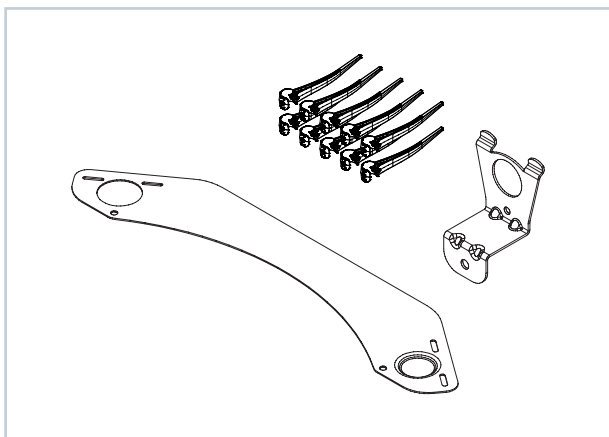

## 5 BAT CENTER

PART #	DESCRIPTION	QTY
174849	FINGER - PLASTIC - PACK OF 10	1
164958	SUPPORT - ENDSHIELD REEL	5
164754	ENDSHIELD - 5 BAT SEGMENTED 5 SERIES	5
135157	SCREW - MACHINE	5
30228	NUT - FLANGE DT SMOOTH FACE 0.375-16 UNC	5
105136	SCREW - MACHINE	5*
50186	NUT - FLANGE LOCK SM FACE DT 0.5-13 UNC GR5	5*
228497	SHIELD-5BAT LH REEL-CAM END	5
228572	SHIELD-5BAT RH REEL-TAIL END	5
273080	SUPPORT - BUSHING ENDSHIELD	5
105137	SCREW-MACHINE, TORX TRUSS HEAD, 3/8 IN, 0.5 IN LG, ZN PL	5
135450	SCREW - MACHINE	10

## 5 BAT END

PART #	DESCRIPTION	QTY
164754	ENDSHIELD - 5 BAT SEGMENTED	5
164958	SUPPORT - ENDSHIELD REEL	5
135157	SCREW - MACHINE	5
30228	NUT - FLANGE DT SMOOTH FACE 0.375-16UNC	5
105136	SCREW-MACHINE	5
50186	NUT - FLANGE LOCK SM FACE DT 0.500-13UNC GR5	5

## 6 BAT CENTER

PART #	DESCRIPTION	QTY
174849	FINGER - PLASTIC - PACK OF 10	1
164958	SUPPORT - ENDSHIELD REEL	6
164965	ENDSHIELD - 6 BAT SEGMENTED 5 SERIES	6
135157	SCREW - MACHINE	6
30228	NUT - FLANGE DT SMOOTH FACE 0.375-16 UNC	6
105136	SCREW - MACHINE	6*
50186	NUT - FLANGE LOCK SM FACE DT 0.5-13 UNC GR5	6*
228496	SHIELD-6BAT LH REEL-CAM END	6
228575	SHIELD-6BAT RH REEL-TAIL END	6
273080	SUPPORT - BUSHING ENDSHIELD	6
105137	SCREW-MACHINE, TORX TRUSS HEAD, 3/8 IN, 0.5 IN LG, ZN PL	6
135450	SCREW - MACHINE	12

## 6 BAT END

PART #	DESCRIPTION	QTY
164965	ENDSHIELD - 6 BAT SEGMENTED	6
164958	SUPPORT - ENDSHIELD REEL	6
135157	SCREW - MACHINE	6
30228	NUT - FLANGE DT SMOOTH FACE 0.375-16UNC	6
105136	SCREW-MACHINE	6
50186	NUT - FLANGE LOCK SM FACE DT 0.500-13UNC GR5	6

*\*Hardware is attached to the reel.*

## Tine Tube Reinforcing Kit

### FITS

All D and FD Series\*, Case 2142/2152/2162, New Holland 82C, 83C, 86C, JD 400D Series

**KIT #** B5825 (5 Bat Reels), B5826 (6 Bat Reels)

### DESCRIPTION

Optional kit to reinforce reel.

### FEATURES/BENEFITS

- » Reinforce reel tine tubes for heavy crop load conditions
- » Prevents tine tube bending

### Notes:

\*Exclude FD2/D2 Series Draper Headers

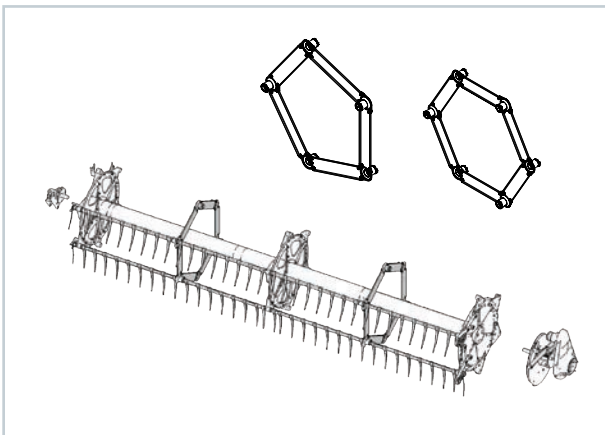

## Multi-Crop Rapid Reel Conversion Kit

### FITS

FD1, D1, FD75, D65, JD 400D Series

**KIT #** B6590

### DESCRIPTION

Allows for quick conversion of reel from factory position to rear canola position

### FEATURES/BENEFITS

- » Ideal for users who often switch back and forth from cereal to canola

### Notes:

\*Also required Short Brace Kit B5605 (Double Reel), or B6401 (Single Reel).

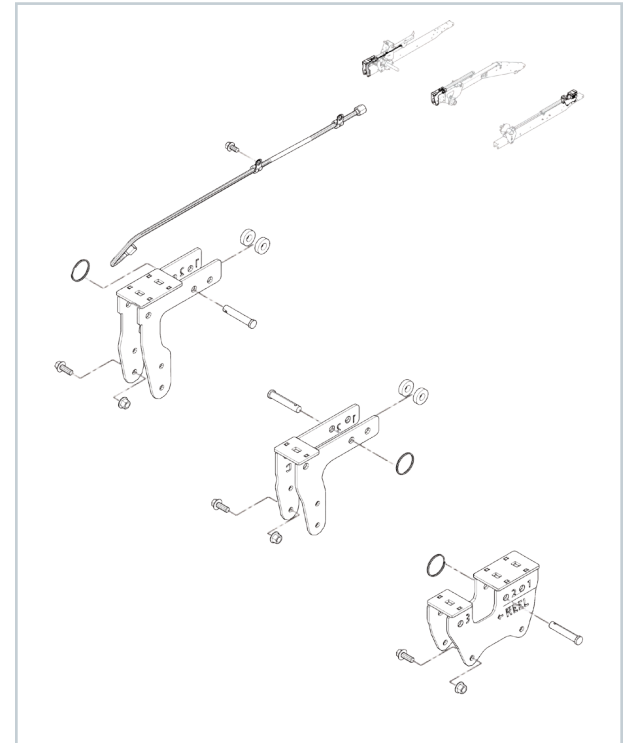

## Solid Feed Auger Fingers

### FITS

FM100 (FD1)

**KIT #** 337152 (Single finger with 337143 guide)

### DESCRIPTION

Replaces hollow finger 287802 in FM100 Feed Auger.

### FEATURES/BENEFITS

- » Solid Feed Auger Fingers undergo a unique heat treatment process known as Austempering to provide a tougher, and more impact resistant structure, for maximum strength and wear characteristics!

#### Notes:

\*Standard on 2021 model year headers.

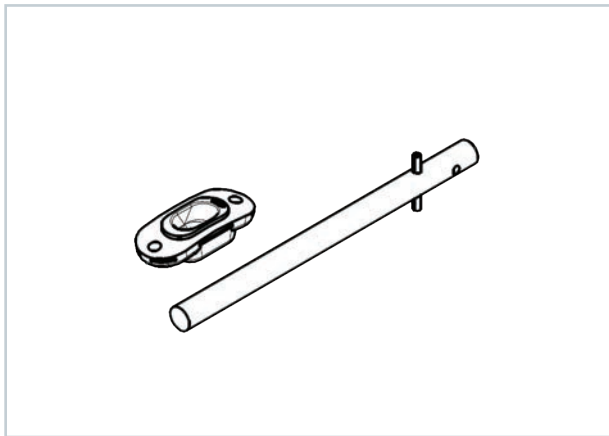

## Split Finger Holders

### FITS

FM100 , CA25, CA25E, CA20, Case 2162/2152/2142 headers

**KIT #** 274276 (CA25, CA20), 276839 (FM100, CA25E)

### DESCRIPTION

A two-piece, bolt together feed auger finger holder (pack of 5).

### FEATURES/BENEFITS

- » Allows for the quick replacement of damaged feed auger finger holders
- » Doesn't require removal of all drum fingers in order to slide over new holder
- » Doesn't require disassembly of drum if spare finger holders run out

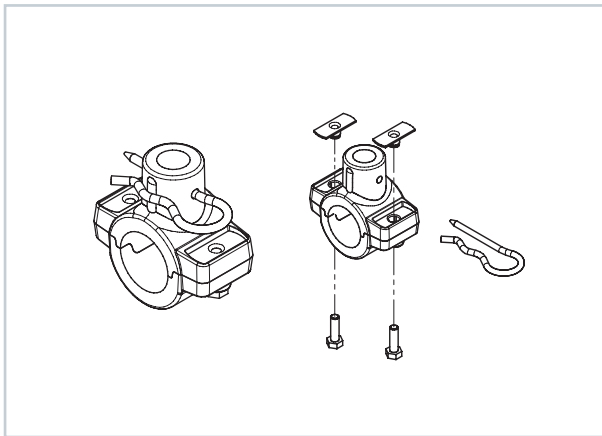

## Auger Dent Repair Kit

### FITS

FM100, CA25, CA25E, CA20, Case 2142/2152/2162, New Holland 82C/83C/86C

**KIT #** 237563

### DESCRIPTION

Kit used to remove dents in the skin of the feed auger. Instructions included.

### FEATURES/BENEFITS

- » Removes dents to auger tube in area of outer finger guides
- » Ensures augers finger holes line up with auger fingers

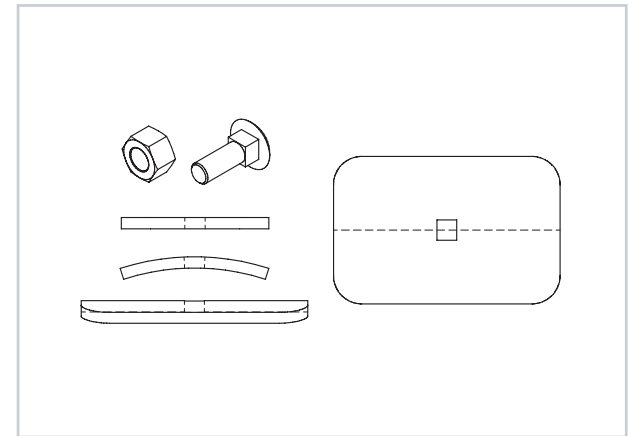



## Feed Auger Finger Hole Repair Kit

### FITS

FM100, CA25, CA20, 873, 872, Case 2142/2152/2162, New Holland 82C/83C/86C

**KIT #** 335464

### DESCRIPTION

Kit makes repairs to finger guide area instead of replacing auger tube.

### FEATURES/BENEFITS

- » Repairs damaged auger finger holes

#### Notes:

\*Some welding is required.

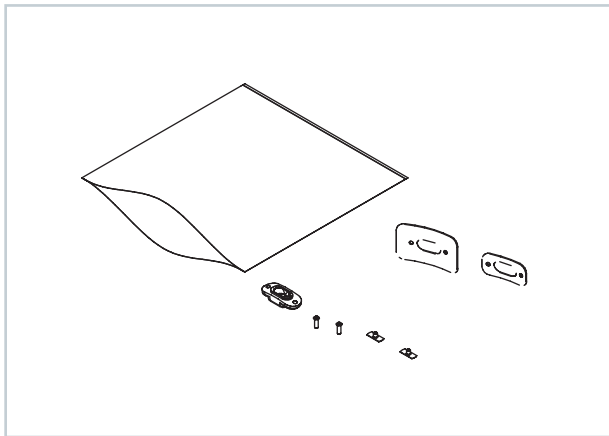

## Seed Saver Kit

### FITS

FD70, D60, D50, Case 2142/2152/2162, New Holland 82C/83C/86C

**PART #** 279028

### DESCRIPTION

Contains corner and center sealing flaps with hardware to aid in sealing gaps between the adapter and header.

### FEATURES/BENEFITS

- » Improved sealing means more of your seed is saved while still retaining the front rock sump
- » Upgrades to latest FD75 specs

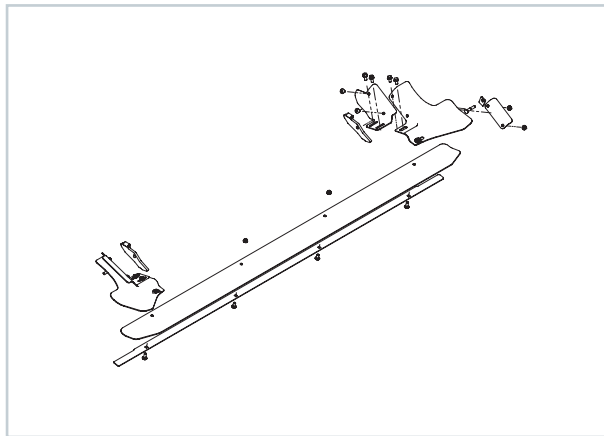

## Auger Flighting Replacement Kit

### FITS

CA25, CA20, Case 2142/2152/2162, New Holland 82C/83C/86C

**KIT #** 294047

### DESCRIPTION

Replacement flighting for feed auger.

### FEATURES/BENEFITS

- » Allows you to replace feed auger flighting which has worn down over time
- » Improved feeding into the combine

#### Notes:

\*Some welding is required.

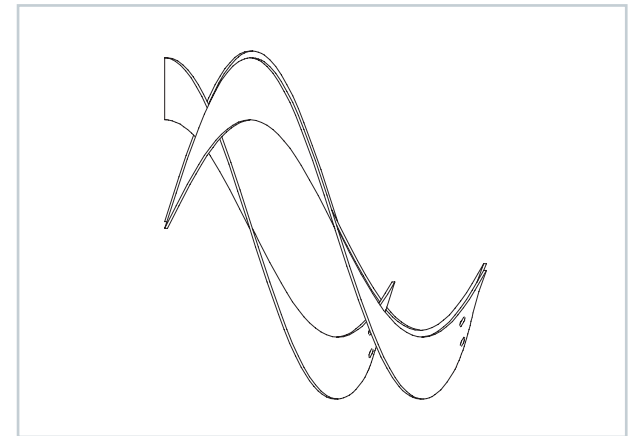

FM100 Auger Flighting Replacement Kit

FITS

FM100

KIT # See Tables

DESCRIPTION

The FM100 bolt on flighting can be replaced as it wears down with the following parts.

FEATURES/BENEFITS

- » The bolt on flighting allows for easy replacement when worn down. No welding is required
- » The new flighting with a laser clad carbide tungsten edge, provides extended life even in the most abrasive conditions

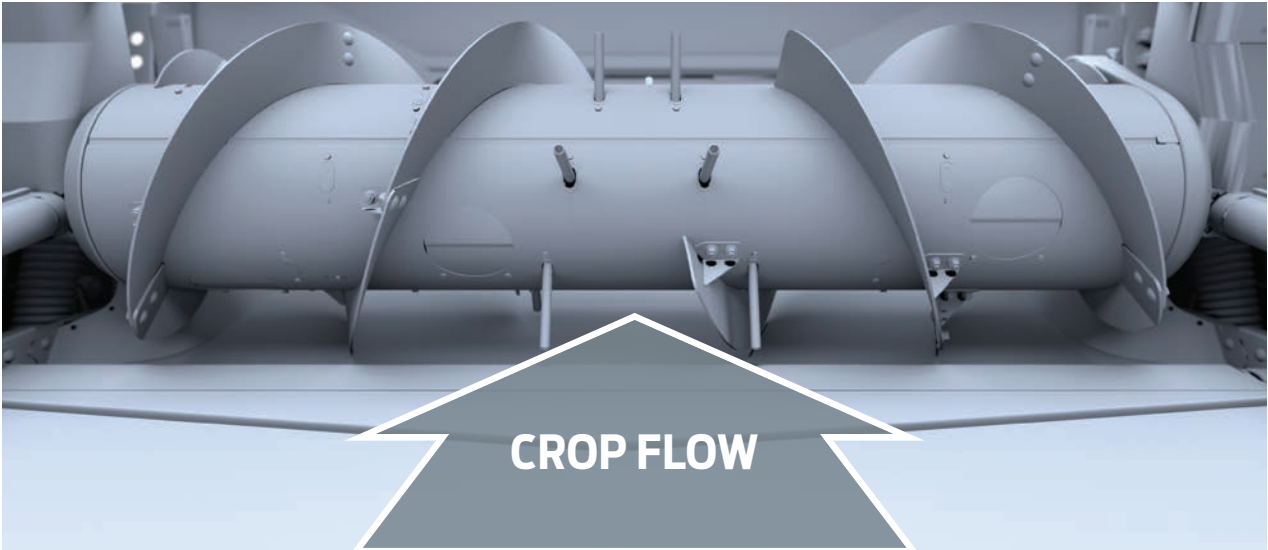
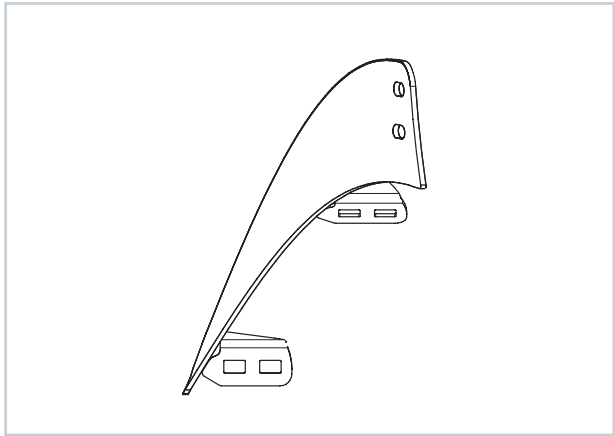

FLIGHTING AND QUANTITY DEPENDS ON DRUM CONFIGURATIONS:

AUGER CONFIGURATION	287887	287888	287889	287890
<b>Standard:</b> Case, New Holland CR Wide, John Deere S-series, Lexion Narrow, Versatile	2	2	-	-
<b>Wide:</b> New Holland CX, John Deere T-series, Lexion Wide, Challenger, Massey	1	1	-	-
<b>Narrow:</b> New Holland CR Narrow, Gleaner	-	-	2	2

## Cutterbar Poly

### FITS

All D and FD Series\*, Case 2142/2152/2162,  
New Holland 82C/83C/86C, JD 400D Series

**PART #** 129297

### DESCRIPTION

Provides a durable and replaceable wear surface when cutting on the ground.

### FEATURES/BENEFITS

- » Guaranteed fit to minimize replacement time
- » Made up of more durable, longer lasting UHMW polyethylene material that is field tested in the toughest real-world conditions
- » MacDon branded for authenticity

HEADER LENGTH	REQUIRED QUANTITIES (#129297)
30 FT	60
35 FT	70
40 FT	80
45 FT	90

#### Notes:

\*Exclude FD2/D2 Series Draper Headers



## Poly Skid Shoes

### FITS

All D and FD Series\*, Case 2142/2152/2162,  
New Holland 82C/83C/86C, JD 400D Series

**PART #** See Table

### DESCRIPTION

Molded plastic skid shoe.

### FEATURES/BENEFITS

- » Guaranteed fit to minimize replacement time
- » Allows cutting height adjustment when cutting on the ground
- » Designed to flex and shed mud in wet conditions

HEADER LENGTH	LEFT HAND	CENTER	RIGHT HAND	TRANSITION PAN
30FT & UNDER	165188	245396 x 2	165386	151551
35FT & OVER	165188	245396 x 4	165386	151551

#### Notes:

\*Center Skid Shoes (part #245396) are a more durable poly design that replaces the steel backing style of older FD70 headers. Consult Parts Catalogue if no skid shoes are currently installed for additional required hardware.

\*Exclude FD2/D2 Series Draper Headers

#### POLY SKID SHOE



#### TRANSITION PAN SKID SHOE



## Steel Skid Shoes

### FITS

FD/D Series Headers\*, Case 2142/2152/2162,  
New Holland 82C/83C/86C, JD 400D Series

**PART #** 313875 (LH), 313873 (RH), 335608 (Inboard)

### DESCRIPTION

Optional replacement for inboard and outboard poly skid shoes.

### FEATURES/BENEFITS

- » Provides increased skid shoe life in abrasive soil conditions

#### Notes:

\*Not recommended in hot dry conditions where fire hazards are present!

\*Exclude FD2/D2 Series Draper Headers



## Front Link Upgrade Kit

### FITS

2011 & Prior FD70, Case 2162, New Holland 86C

**KIT #** 123719

### DESCRIPTION

Replaces chain link with solid link and ball joint connections.

### FEATURES/BENEFITS

- » A more secure connection between the adapter and the header
- » Greatly reduces the chances of feed deck damage
- » Upgrades to latest FD75 specs

#### Notes:

*\*Some welding is required.*

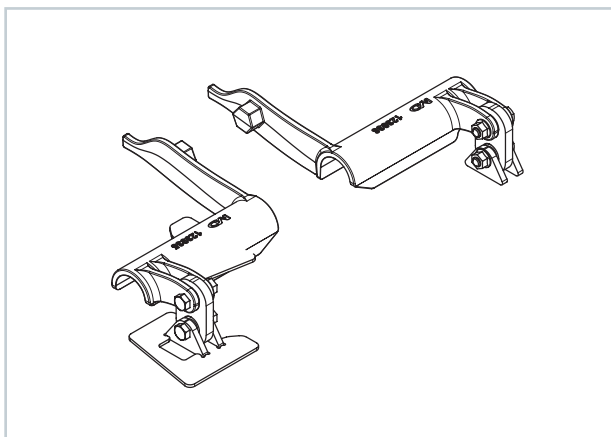

## Compression Link Upgrade Kit

### FITS

All FD70's, Case 2162, New Holland 86C

**PART #** 245810

### DESCRIPTION

Can be used to replace the compression link bushing system on FD70 FlexDraper Headers with a ball joint system.

### FEATURES/BENEFITS

- » Improves wing performance and durability
- » Replaces bushing system with a ball joint system
- » Upgrades to latest FD75 specs

#### Notes:

*\*This kit contains enough pieces to do both sides.*

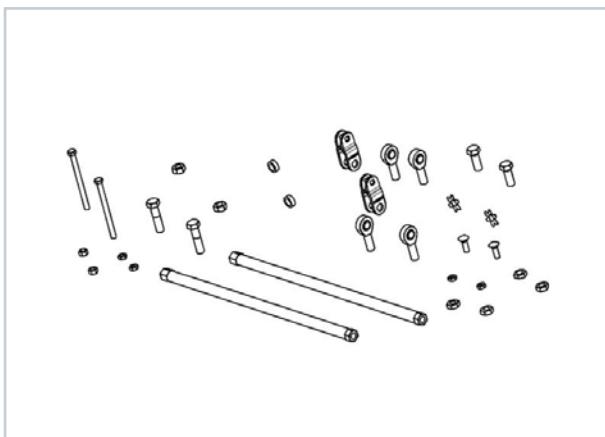

## Fill Tube Extension Kit

### FITS

All D and FD Series, Case 2142/2152/2162, New Holland 82C, 83C, 86C

**PART #** 312824

### DESCRIPTION

Hydraulic reservoir filler extension kit.

### FEATURES/BENEFITS

- » Allows reservoir to be fully filled for working in extreme hills
- » Prevents pump cavitation at extreme angles
- » Recommended when header is used on a combine equipped with leveling system (Hilco, etc.)

#### Notes:

*\*Comes with gaskets and hardware, not serviced separately. Kit available through whole goods only.*

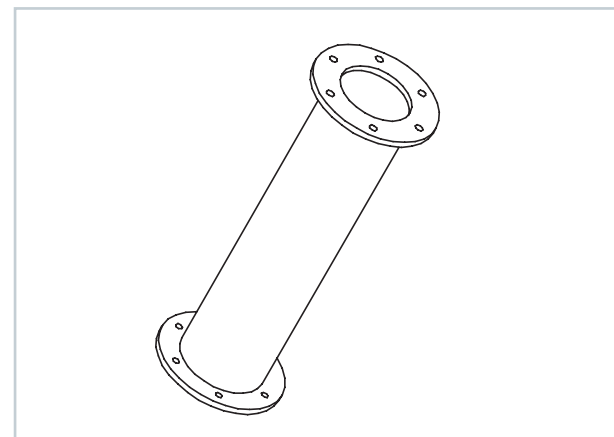

Aluminum Gearbox Upgrade

FITS

CA20 prior to 2012, Case 2162/2152 prior to 2012

**KIT #** 279831 (Case/JD) or 294008 (Lexion/AGCO)

DESCRIPTION

Aluminum gearbox and input shaft.

FEATURES/BENEFITS

- » Updates adapter gearbox to CA25 design
- » Increased reliability and durability with fully aluminum design

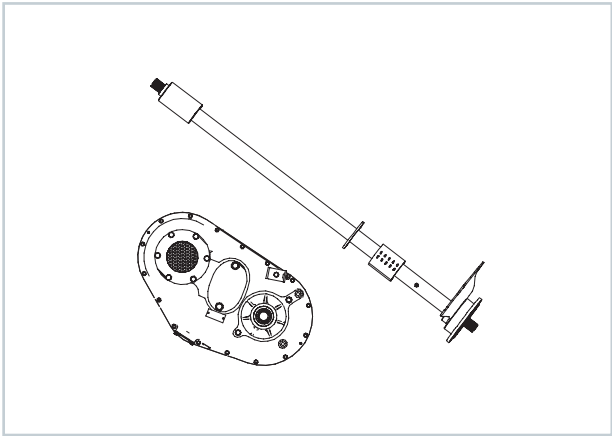

Foot Switch

FITS

FM100/CA25

**PART #** 287537

DESCRIPTION

This footswitch is used to switch between reel fore-aft/header tilt and can be used as an alternative to the switch on the console.

FEATURES/BENEFITS

- » Allows user to toggle between fore-aft and header tilt with your foot, leaving two hands available for other combine controls

Notes:

*\*Available for AGCO and John Deere combines only.*

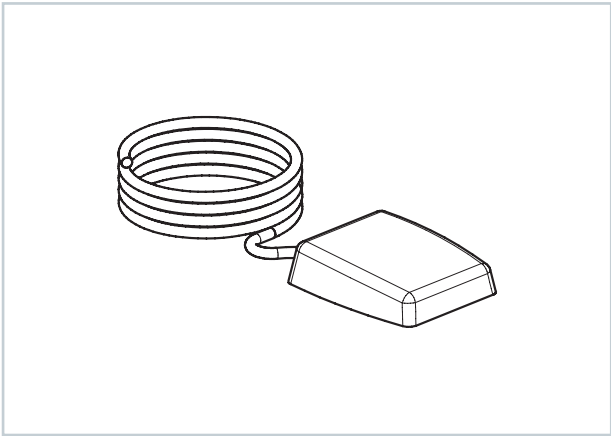

Dual Sensor AHHC Kit

FITS

FD1/D1 (FM100)

**KIT #** 248783

DESCRIPTION

Allows for lateral tilt to work with automatic header height control

FEATURES/BENEFITS

- » Provides optimum header tracking to aid floating in all field conditions

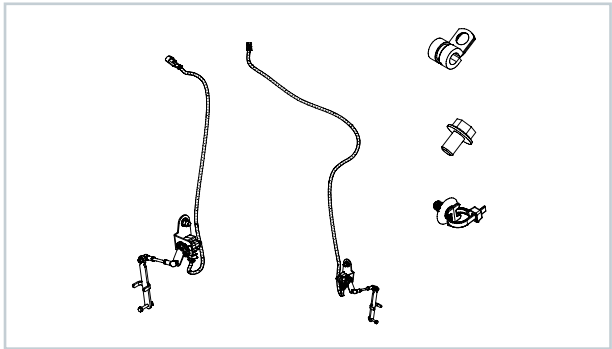

Paint

PART NUMBER	DESCRIPTION
23950	PAINT - AEROSOL, RED II
23956	PAINT - LITER, RED C
25991	PAINT - LITER, BLACK W/C
135148	PAINT - AEROSOL, BLACK W/C
32879	PAINT - AEROSOL, WHITE
32880	PAINT - LITER, RED II



Take FlexDraper® performance over the top!

MacDon FD Series FlexDraper® Headers are designed to contour to the ground on rolling terrain for a close even cut. However, when cutting off the ground, the FlexDraper frame is locked into rigid mode. This setting limits the FlexDraper’s ability to contour over rolling terrain. The ContourBuddy™ System solves that by allowing FlexDrapers to be used in Flex mode while cutting off the ground.

The ContourBuddy™ is a simple mechanical system that uses strategically placed wheels under the FlexDraper. This design takes full advantage of the FlexDraper’s Flex/Float system while cutting off the ground. Using the ContourBuddy™ sets you up for next year’s seeding with a consistently even stubble height.



CONTOURBUDDY™ FEATURES & BENEFITS
Full flex and AHH cutting off the ground
Reduced operator input
Consistent stubble height
Reduce digging/picking stones
Eliminates need for gauge wheels (up to 10" stubble height)

CONTOURBUDDY™ COMPATIBILITY	
MacDon FD70 FlexDraper®	✓
MacDon FD75 FlexDraper®	✓
MacDon Series FD1 FlexDraper®	✓
CASE IH 2162	✓
New Holland 86C	✓

ContourBuddy™

FITS

FD70, FD75, FD1, Case 2162

PART # 284819

DESCRIPTION

Mechanical system that uses strategically placed wheels under the MacDon Flexdraper.

FEATURES/BENEFITS

» This design takes full advantage of the Flexdraper’s Flex/Float system while cutting off the ground. Using the ContourBuddy™ sets you up for next year’s seeding with a consistently even stubble height.

Notes:

*\*Outer skid shoe mounting brackets are required for installation (sold separately)*

