

**IMPORTANT**

**Insert the following five pages into the  
M100 Self-Propelled Windrower OPERATOR'S MANUAL, Form #169304.**

Inside Front Cover  
(blank)

# OPERATOR'S STATION

## 5.17.2.1 Display Selector Switch



Selects and displays the settings in the CDM (B) top line read-out for each of the header controls. Press switch to scroll through settings.

## 5.17.2.3 Header Position Switches

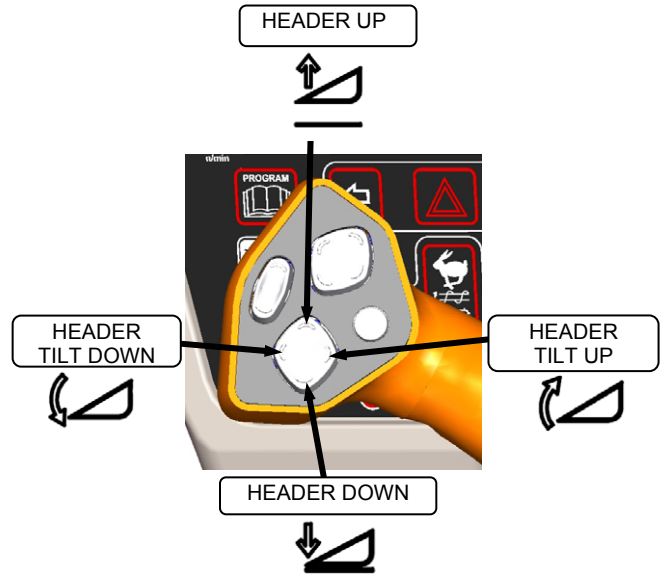

Press and hold switch at location shown to move header. Release switch at desired position.

## 5.17.2.2 Reel Position Switches

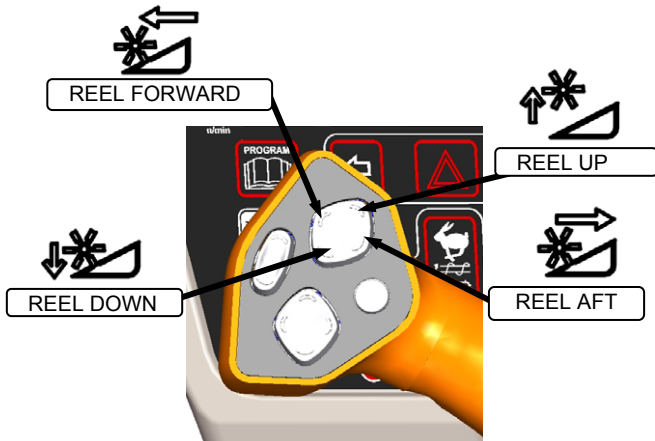

### NOTE

*Reel position switches work only on draper headers.*

Press and hold switch at location shown to move reel. Release switch at desired position.

## 5.17.2.4 Reel Speed Switches

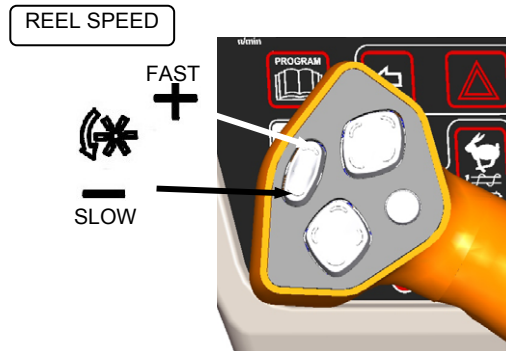

Press and hold switch at location shown to change reel speed. Release switch at desired speed.

### NOTE

*Auger speed adjusts proportionately when reel speed is changed. See Section 6 for further details.*

**This page intentionally left blank**

# OPERATOR'S STATION

## 5.18 CAB DISPLAY MODULE (CDM)

### 5.18.1 Engine and Windrower Tractor Functions

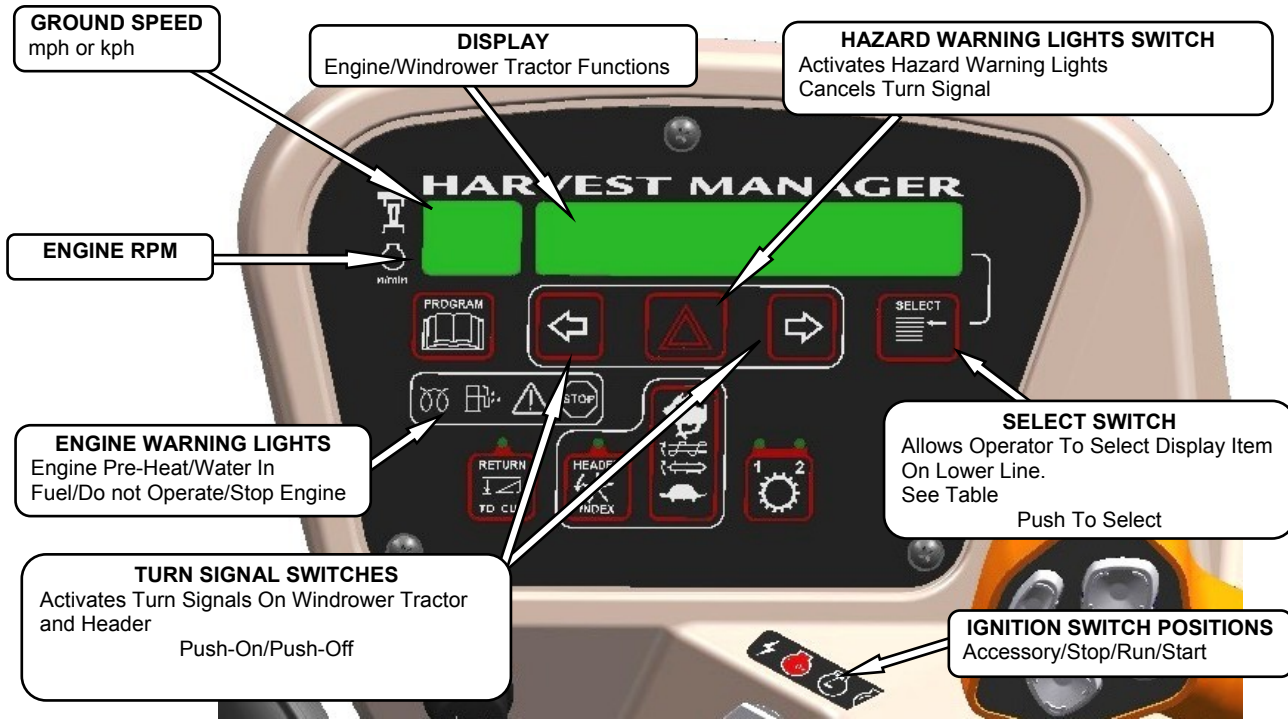

### 5.18.2 Header Functions

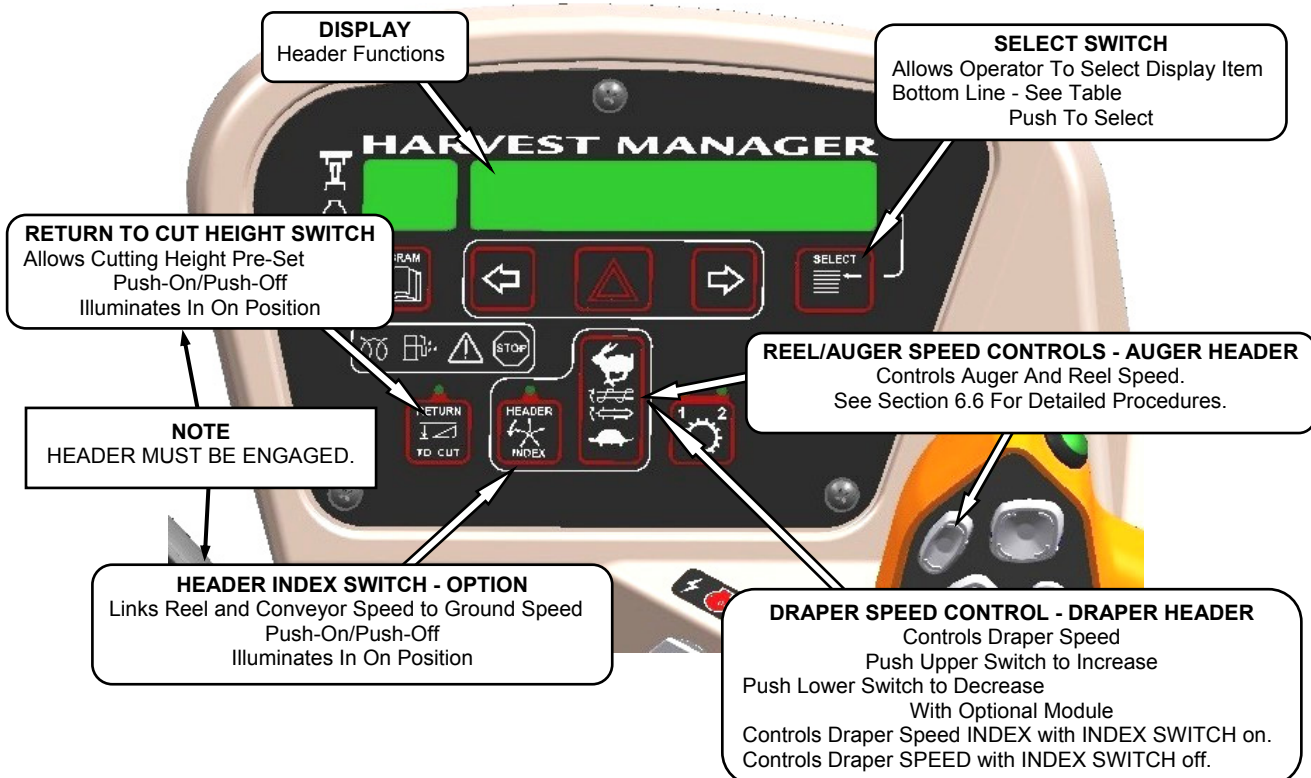

**This page intentionally left blank**

## HEADER OPERATION – D SERIES

### 6.5.5 Knife Speed

The ideal cutting speed of the knife should be such that a clean cut is achieved. Crop types and conditions usually influence the knife and forward speeds.

The knife speed is manually set by making adjustments to the knife drive pump and has been pre-set at the factory. For optimum performance, adjust the knife speed according to the header being used. See the following table.

If the machine is equipped with the appropriate sensor and optional module, the CDM will notify the operator when the knife speed reaches an overload pre-set (usually 75% of knife speed). The pre-set can be changed on the CDM. Refer to Section 5.18.5 CDM Programming

#### NOTE

*The knife speed should stay within the range specified for each header.*

HEADER DESCRIPTION		KNIFE SPEED			
TYPE	SIZE	MINIMUM		MAXIMUM	
		RPM	SPM	RPM	SPM
Draper DK	15	750	1500	950	1900
Draper DK	20 & 25	700	1400	850	1700
Draper DK	30	600	1200	800	1600
Draper DK	35			700	1400
Draper SK	20 & 25			750	1500
Draper SK	30	550	1100	700	1400
Draper SK	35			700	1400

RPM = speed of wobble box pulley.

SPM = strokes per minute of knife (RPM x 2).

- a. Determine the knife speed as follows if the machine is not equipped with the optional module:



### CAUTION

**Check to be sure all bystanders have cleared the area.**

1. Run engine at 2600 rpm with the header drive engaged and with ISC off.

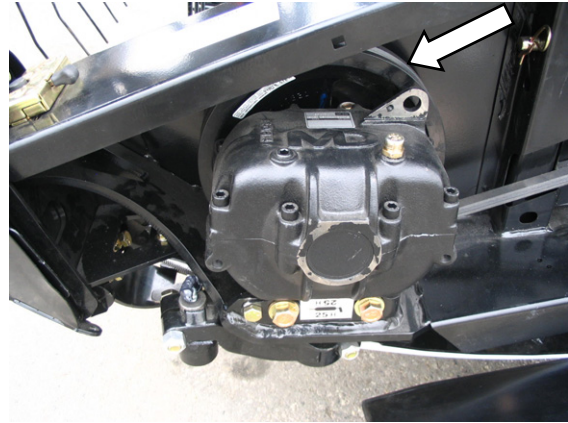

2. Check wobble box pulley speed with a hand-held tachometer.
  3. Multiply the rpm reading by two for the knife speed in strokes per minute.
- b. Determine the knife speed as follows if the machine is equipped with the optional module:
1. Run engine at 2600 rpm with the header drive engaged and ISC off.

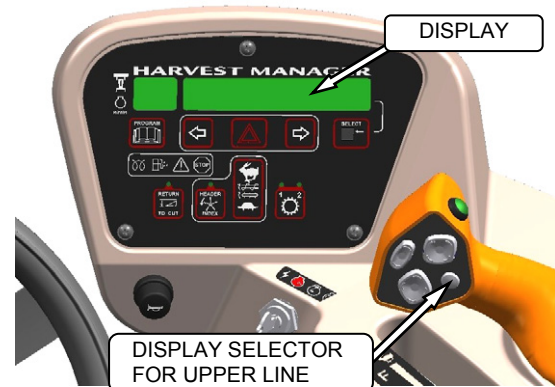

2. Press SELECTOR button on the GSL until the CDM displays the knife speed in SPM.
- c. If required, adjust knife speed as follows:



### DANGER

**Stop engine and remove key from ignition before leaving operator's seat for any reason. A child or even a pet could engage an idling machine.**

1. Shutdown engine.

*(continued next page)*

## HEADER OPERATION – D SERIES

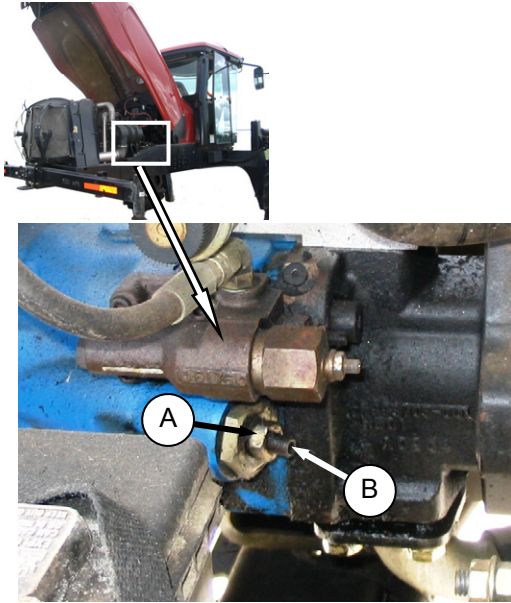

2. Loosen jam-nut (A).
3. Turn adjuster screw (B) clockwise to decrease knife speed, and counter-clockwise to increase the knife speed.

### NOTE

*One turn of the adjuster screw will change the knife speed by approximately 116 strokes per minute, or the wobble box pulley speed by 58 revolutions per minute.*

4. Once adjustment has been made re-torque jam nut (A) as shown.
- d. Start engine and recheck knife speed.



## HEADER OPERATION – A SERIES

### 6.6.4 Knife Speed

The ideal cutting speed of the knife should be such that a clean cut is achieved. Crop types and conditions usually influence the knife and forward speeds.

The knife speed is manually set by making adjustments to the knife drive pump and has been pre-set at the factory. For optimum performance, adjust the knife speed according to the header being used. See the following table.

If the machine is equipped with the appropriate sensor and optional module, the CDM will notify the operator when the knife speed reaches an overload pre-set (usually 75% of knife speed). The pre-set can be changed on the CDM. Refer to Section 5.18.5 CDM Programming

#### NOTE

*The knife speed should stay within the range specified for each header.*

HEADER DESCRIPTION		KNIFE SPEED			
TYPE	SIZE	MINIMUM		MAXIMUM	
		RPM	SPM	RPM	SPM
Auger A40D	All	700	1400	950	1900
Auger A30D		775	1550		
Auger A30S		625	1250	775	1550

RPM = speed of wobble box pulley.

SPM = strokes per minute of knife (RPM x 2).

- a. Determine the knife speed as follows if the machine is not equipped with the optional module:



### CAUTION

**Check to be sure all bystanders have cleared the area.**

1. Run engine at 2600 rpm with the header drive engaged and with ISC off.

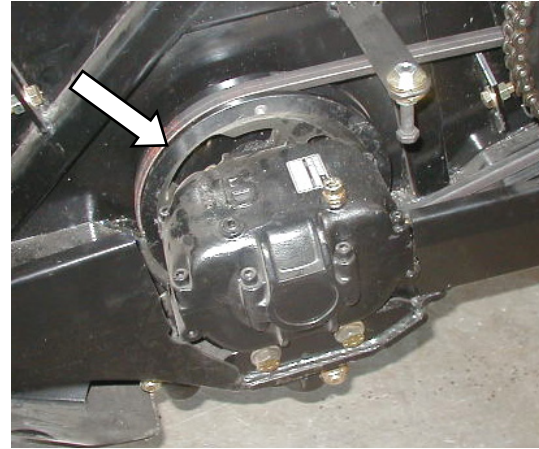

2. Check wobble box pulley speed with a hand-held tachometer.
  3. Multiply the rpm reading by two for the knife speed in strokes per minute.
- b. Determine the knife speed as follows if the machine is equipped with the optional module:
1. Run engine at 2600 rpm with the header drive engaged and ISC off.

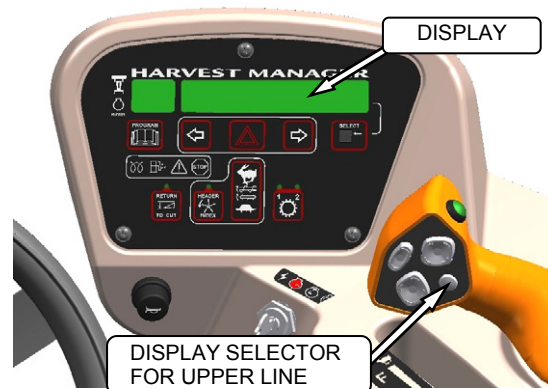

2. Press SELECTOR button on the GSL until the CDM displays the knife speed in SPM.
- c. If required, adjust knife speed as follows:



### DANGER

**Stop engine and remove key from ignition before leaving operator's seat for any reason. A child or even a pet could engage an idling machine.**

1. Shutdown engine.

*(continued next page)*

## HEADER OPERATION – A SERIES

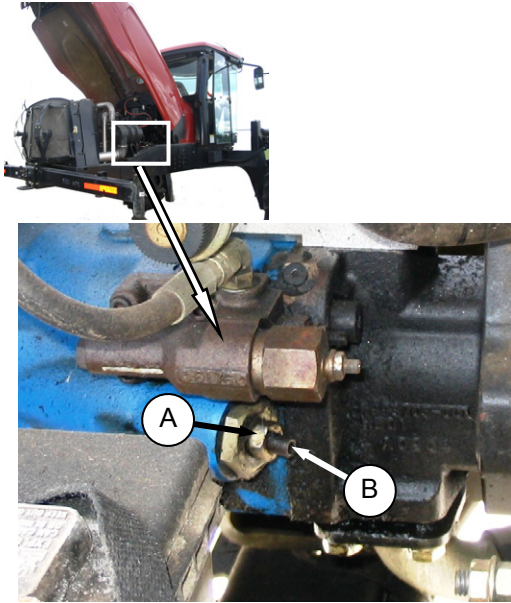

2. Loosen jam-nut (A).
3. Turn adjuster screw (B) clockwise to decrease knife speed, and counter-clockwise to increase the knife speed.

### NOTE

*One turn of the adjuster screw will change the knife speed by approximately 116 strokes per minute, or the wobble box pulley speed by 58 revolutions per minute.*

4. Once adjustment has been made re-torque jam nut (A) as shown.
- d. Start engine and recheck knife speed.

# HEADER OPERATION – A SERIES

## 6.6.5 Reel Speed

### 6.6.5.1 A30-S and A30-D Headers

The reel speed is fixed to the auger speed and to the knife speed. Both can be changed by installing alternate drive sprockets. Refer to your Auger Header Operator's Manual.

### 6.6.5.2 A40-D Header

The A40-D auger header features a hydraulic direct drive reel with operating speed range of 51 to 76 rpm and is controlled with switches on the CDM, and on the GSL at the operator's station. The hydraulic flows for the reel and auger are interconnected so that the auger and reel speeds are controlled using a combination of the CDM switches and the GSL switches.



## CAUTION

Check to be sure all bystanders have cleared the area.

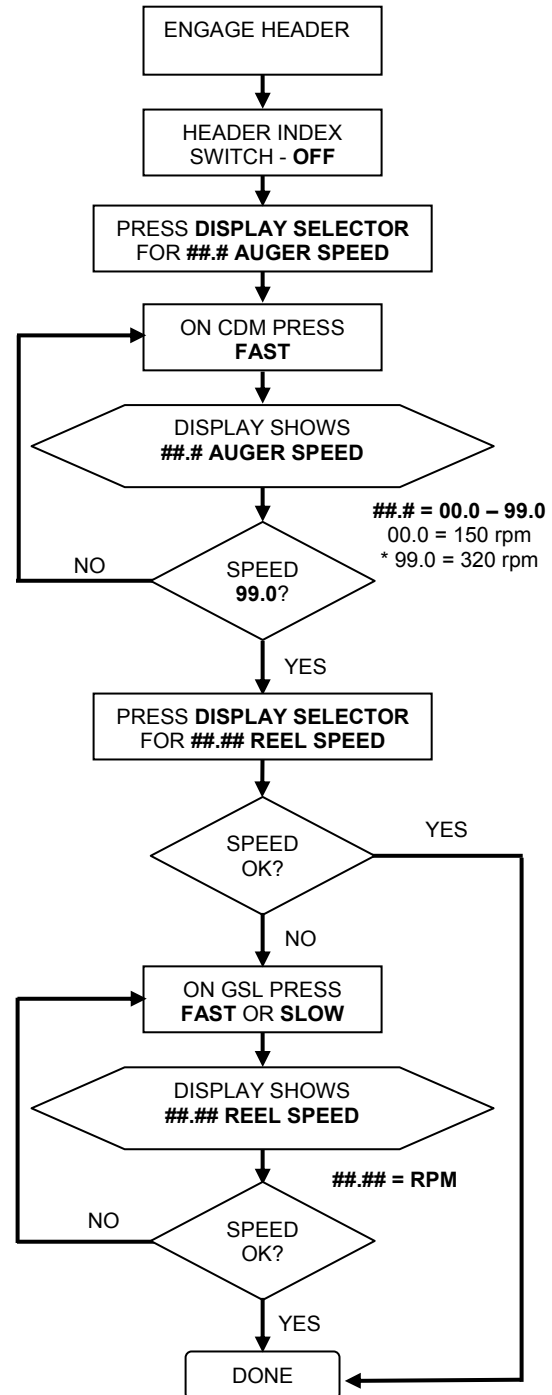
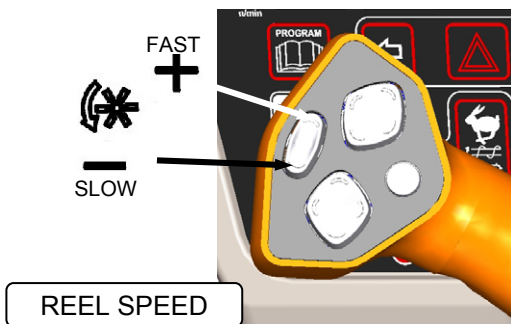
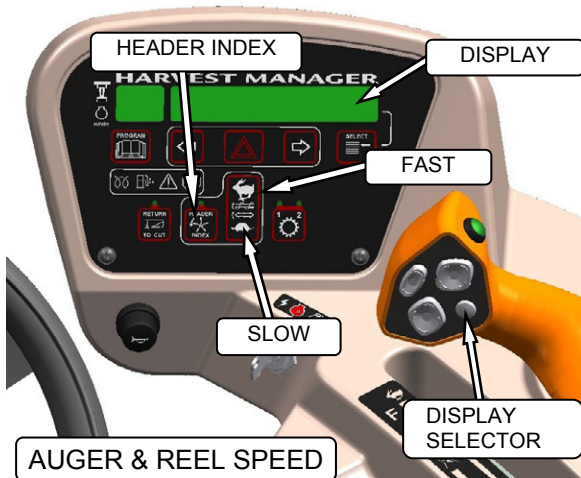

\* Auger Speed Not To Exceed 320 rpm.