

MacDon *Performance Parts*



Auger Headers

Reel Tine Hardware

FITS

A40D, A40D GS 2015 & prior

PART # 6 Bat - 170622 (x18), 136348 (x9), 21569 (x9)
7 Bat - 170622 (x21), 136348 (x11), 21569 (x10)

DESCRIPTION

Used to update reel tine bolts with stronger, updated bolts.

FEATURES/BENEFITS

- » Increased strength of reel tine tube bolts
- » Increased life of reel tine tube bolts

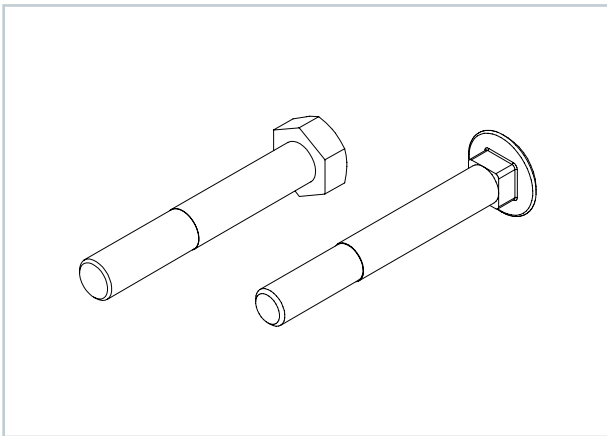

Swath Baffle Adjuster Brace Kit

FITS

A Series Header

KIT # 170585

DESCRIPTION

New adjuster bracket for A-series auger header baffle.

FEATURES/BENEFITS

- » Stronger and more reliable baffle adjuster bracket

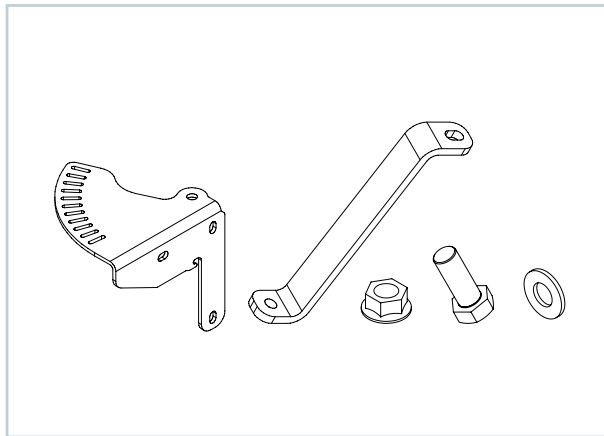

Auger Edge Flighting Repair Kit

FITS

A40 Header

KIT # 170436

DESCRIPTION

Used to repair worn auger flighting.

FEATURES/BENEFITS

- » Increased auger life
- » More consistent crop feeding throughout header

Notes:

**Some welding is required.*

Full Flighting Repair Kit

FITS

A Series Header

KIT # 143147 (LH), 143142 (RH)

DESCRIPTION

Used to fully replace worn auger flighting.

FEATURES/BENEFITS

- » Increased auger life
- » More consistent crop feeding throughout header

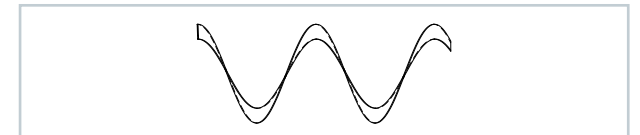

Notes:

**Some welding is required.*

Sickle Sections

FITS

All Auger Header Models

PART

294947 (Ultra coarse serrated, 4SPI, 25 Pack), 279641 (Coarse serrated, 9 SPI, 25 Pack), 279642 (Fine serrated, 14 SPI, 25 Pack)

DESCRIPTION

MacDon Sickle Sections undergo a unique heat treatment process known as Austempering to provide a tougher, and more impact resistant structure, for maximum strength and wear characteristics! Can be used in any harvest situation, designed and engineered to perform better than standard sickle sections.

FEATURES/BENEFITS

- » Austempered sickle sections are made up of substantially tougher, longer lasting material that has proven less chipping, fewer broken sections and noticeably less wear
- » Designed to self sharpen as they wear, meaning your sickle sections will continue to stay sharp throughout the section life
- » Guaranteed hole spacing means your replacement sickle section will fit your MacDon perfectly every time, inconsistently spaced holes lead to premature bolt failure costing valuable downtime

Notes:

* Non-Austempered sickle sections are also available as 174845 (Coarse serrated, Busatis), 118491 (Fine serrated, Busatis).

When choosing your knife, choose a serration based on the types of crops you are cutting.



Ultra-coarse sections are recommended for thicker stemmed crops and adverse soybean conditions.



Coarse sections are recommended for cereals, canola, pulses and soybeans.



Fine sections are recommended for use in forage, grasses and thin stemmed crops like flax and lentils.

Guards

FITS

All Auger Header Models

PART

Pointed Guard: 118344 (Double heat-treated), 118484 (Single heat-treated), 118301 (Left hand end), 118302 (Right hand end), 118345 (No knife ledgers, for drive end)

Stub Guard: 34359 (Double heat-treated top), 118346 (Double heat-treated bottom), 135586 (Single heat-treated top), 135575 (Single heat-treated bottom), 118351 (Sheet metal top)

DESCRIPTION

All MacDon guards are fully thru-hardened for toughness, then induction hardened in key high wear areas so they will keep their cutting edge longer. Single heat treated guards only recommended for use in conditions where guards break before they wear out.

FEATURES/BENEFITS

- » Cutting surface is induction hardened providing targeted hardening in high contact areas, resulting in a superior cutting performance
- » Critical dimensions ensure a perfect fit on your MacDon machine every time, allowing for minimal downtime and quick replacements
- » Tapered edge design allows for sickle sections to be replaced without replacing guard

POINTED GUARD



STUB BOTTOM GUARD



SHEET METAL TOP



FORGED METAL TOP



Recommended Cutting Components Combinations

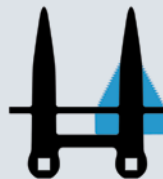

Pointed Guard

Recommended

- » For rocky conditions
- » On ground applications



Stub Guard

Recommended

- » For off ground application
- » Tough cutting conditions