

PARTS CATALOG

Series I
AUGER HEADER
and
HAY CONDITIONER

for Series I ("Hydro-Mac") S.P. Windrower



FORM NO. 12514

1/89

MacDon Industries Ltd.

680 Moray Street, Winnipeg, Manitoba
Canada R3J 3S3
(204) 885-5590, Fax 832-7749
Telex 07-57849

AUGER HEADER & HAY CONDITIONER Parts Index

Main Frame -----	2
Drive Shaft -----	4
Gear Box -----	6
Knife & Knife Drive -----	8
Wobble Box -----	10
Auger & Auger Drive -----	12
Reel & Reel Drive -----	14
Shields & Decals -----	16
Hay Conditioner:	
Frame & Shields -----	18
Drive -----	20
Chains -----	21
Numerical Parts Listings -----	22

Note: RIGHT HAND and LEFT HAND, as used in this catalogue, refers to the position standing behind the machine facing forward (the direction of travel). Where necessary, arrows have been included to indicate the front of the machine.

When ordering parts, be sure you have the serial number of your Auger Header, or Auger Header Hay Conditioner. They are located as follows:

Auger Header -----	Top of R/H end sheet
Hay Conditioner -----	L/H side of conditioner top sheet

MAIN FRAME

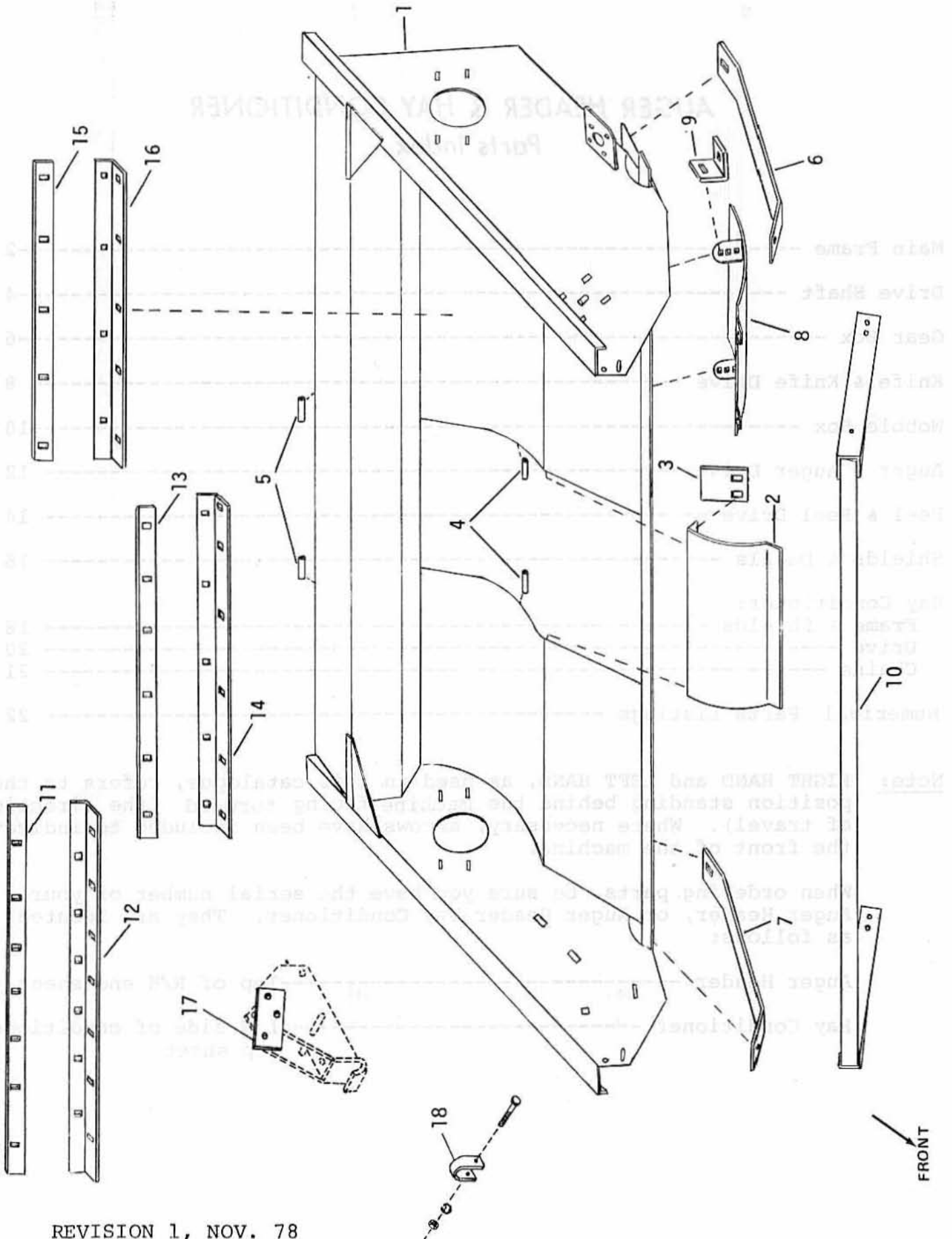

REF.	PART NO.	DESCRIPTION	QTY.	SERIAL NUMBER
1	K-19130-1	Auger header frame - 12 ft. only	1	
	K-19244-1	Auger header frame - 14 ft. only	1	
2	K-18472-1	Front centre deck	1	-51461
	K-22965-1	Front centre deck	1	51462-
3	K-18192-1	Deck support	3	
4	K-19680-1	Lower spacer - 1.0 O.D. x .180 wall x 3.75 long	2	
5	K-19228-1	Top spacer - 1.0 O.D. x .180 wall x 3.40 long	2	
6	K-22871-1	L/H shoe pad	1	
7	K-19087-1	R/H shoe pad	1	
8	K-22906-1	Float shoe	2	
9	K-18485-1	Float shoe mount	4	
10	K-19187-2	Lean bar c/w decals - 12 ft. only	1	
	K-19188-2	Lean Bar c/w decals - 14 ft. only	1	
11	K-22545-1	R/H stripper bar extension - 14 ft. only	2	
12	K-22866-1	R/H Stripper Bar - 14 ft. only	2	
13	K-22544-1	R/H Stripper Bar Extension - 12 ft. only	2	
		L/H Stripper Bar Extension - 14 ft. only	2	
14	K-22865-1	R/H Stripper Bar - 12 ft. only	2	
		L/H Stripper Bar - 14 ft. only	2	
15	K-22543-1	L/H Stripper Bar Extension - 12 ft. only	2	
16	K-22864-1	L/H Stripper Bar - 12 ft. only	2	
17	K-22950-1	R/H Float Plate (14 ft. Only)	2	
18	K-23000-1	Cylinder Stop	2	

REF.	PART NO.	DESCRIPTION	QTY.	SERIAL NUMBER
1		See gear box - complete - Page 6		
2	P-2149	Woodruff key #808 (.25 thk. x 1" dia.)	3	
3	K-19751-2	U-Joint assembly (includes items 4,5 & 6)	2	
4	P-18919	Rear yoke (one per assembly)	2	
5	P-18922	Cross & bearing kit (one per assembly)	2	
6	P-21156	Front yoke (one per assembly)	2	
7	P-18908	Sq.Hd. cup point setscrew .38 NC x 1.0 Long	4	
8	P-18664	Jam nut .375 NC	4	
9	K-19483-1	L/H drive shaft - 12 ft. only	1	
	K-18190-1	L/H drive shaft - 14 ft. only	1	
10	K-18909-1	R/H drive shaft - 12 ft. only	1	
	K-19471-1	R/H drive shaft - 14 ft. only	1	
11	P-13298	Woodruff key #809 (.25 THK x 1.13 dia.)	4	
12	K-22855-1	Bearing mount	1	
13	K-23651-1	Flange block c/w bearing & locking collar (includes item 14)	3	
14	P-7295	Bearing c/w locking collar	3	
15	K-19117-1	Tapered bore sprocket	1	
16	K-7038-1	Key .25 x .25 x 2" long	1	
17	P-21246	Split taper bushing c/w bolts & key	1	
18	K-22758-1	Knife drive pulley	1	
19	P-21214	Split taper bushing c/w bolts	1	
20	K-19092-2	Sprocket c/w brass bushing	1	
21	K-19482-1	Shear block	1	
22	P-18534	Capscrew .25 NC x 1.5 long	5	
23	K-22239-2	U-Joint Assembly (includes items 24-28)	1	
24	P-21490	End yoke	1	
25	P-18922	Cross & Bearing Kit	1	
26	P-21057	Yoke & shaft	1	
27	P-20504	Nylon bearing	1	
28	P-21210	Plastic shield	1	

GEAR BOX

REF.	PART NO.	DESCRIPTION
1		See gear box - complete - Page 6
2	P-2149	Woodruff Key 1/8" x 1/2" x 1/4"
3	K-19721-2	U-bolts assembly (includes frame 1/2" x 1/2")
4	P-18919	Rear yoke (one per assembly)
5	P-18921	Crown & bearing kit (one per assembly)
6	P-2152	Front yoke (one per assembly)
7	P-18908	Sp.Hd. cup point
8	P-18884	Jam nut - 3/8" NC
9	K-19487-1	1/8" drive shaft
10	K-18190-1	1/8" drive shaft
11	K-18190-1	1/8" drive shaft
12		Locking pin
13		Locking pin
14		Locking pin
15		Locking pin
16		Locking pin
17		Locking pin
18		Locking pin

REF.	PART NO.	DESCRIPTION	QTY.	SERIAL NUMBER
	K-19658-2	Gearbox - complete	1	
1	P-21376	Bearing cone	1	
2	P-7900	Bearing cup	1	
3	P-21440	Tapered key	2	
4	P-21435	Gear	2	
5	P-21438	Retaining ring	3	
6	P-21432	Bearing cone	3	
7	P-21433	Bearing cup	3	
8	P-21439	Thrust collar	1	
9	P-21434	Seal	3	
10	P-21436	Short Shaft	1	
11	P-21437	Long Shaft	1	
12	P-21442	Plug, vented	1	
13	P-21441	Plug, plain	2	
14	P-21087	Capscrew, 5/16 NC x 1"	24	
15	P-21670	Housing	1	
16	P-21671	Cap	3	
17	P-21673	Gasket, 0.015"	A/R	
	P-21674	Gasket, 0.005"	A/R	
	P-21675	Gasket, 0.003"	A/R	
	P-21676	Gasket, 0.002"	A/R	
18	P-21677	Shim, 0.002"	A/R	
	P-21678	Shim, 0.005"	A/R	
	P-21679	Shim, 0.010"	A/R	

7

KNIFE & KNIFE DRIVE

DESCRIPTION

PART NO.

REF.

K-1928-2	Gearbox - complete	1
P-21375	Bearing cone	2
P-17000	Bearing cup	3
P-21440	Tapered key	4
P-21435	Gear	5
P-21438	Retaining ring	6
P-21432	Bearing cup	7
P-21433	Bearing cup	8
P-21439	Washer collar	9
P-21434	Seal	10
P-21430	Short shaft	11
P-21437	Long shaft	12
P-21435	Pin	13
P-21436	Pin	14
P-21437	Pin	15
P-21438	Pin	16
P-21439	Pin	17
P-21440	Pin	18
P-21441	Pin	19
P-21442	Pin	20
P-21443	Pin	21
P-21444	Pin	22
P-21445	Pin	23
P-21446	Pin	24
P-21447	Pin	25
P-21448	Pin	26
P-21449	Pin	27

to K-22758
on drive shaft

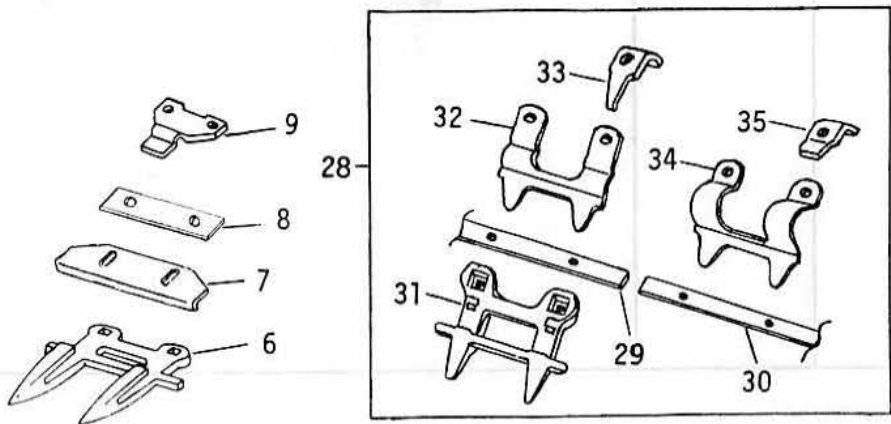
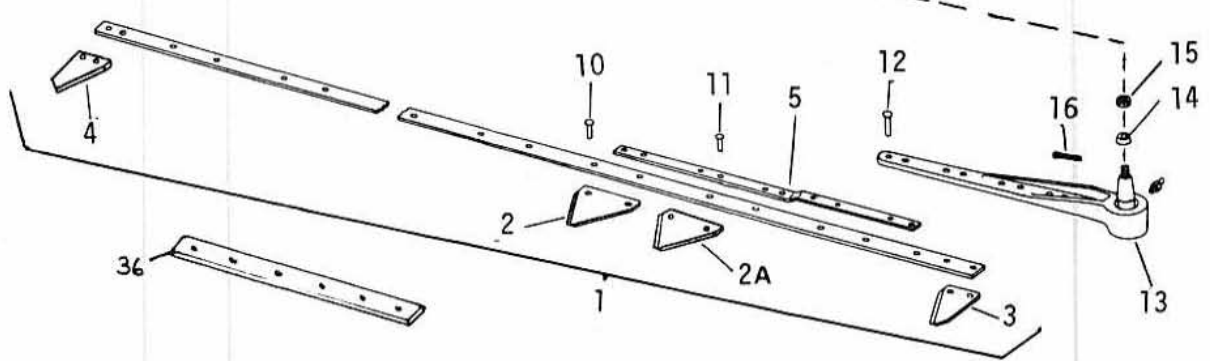
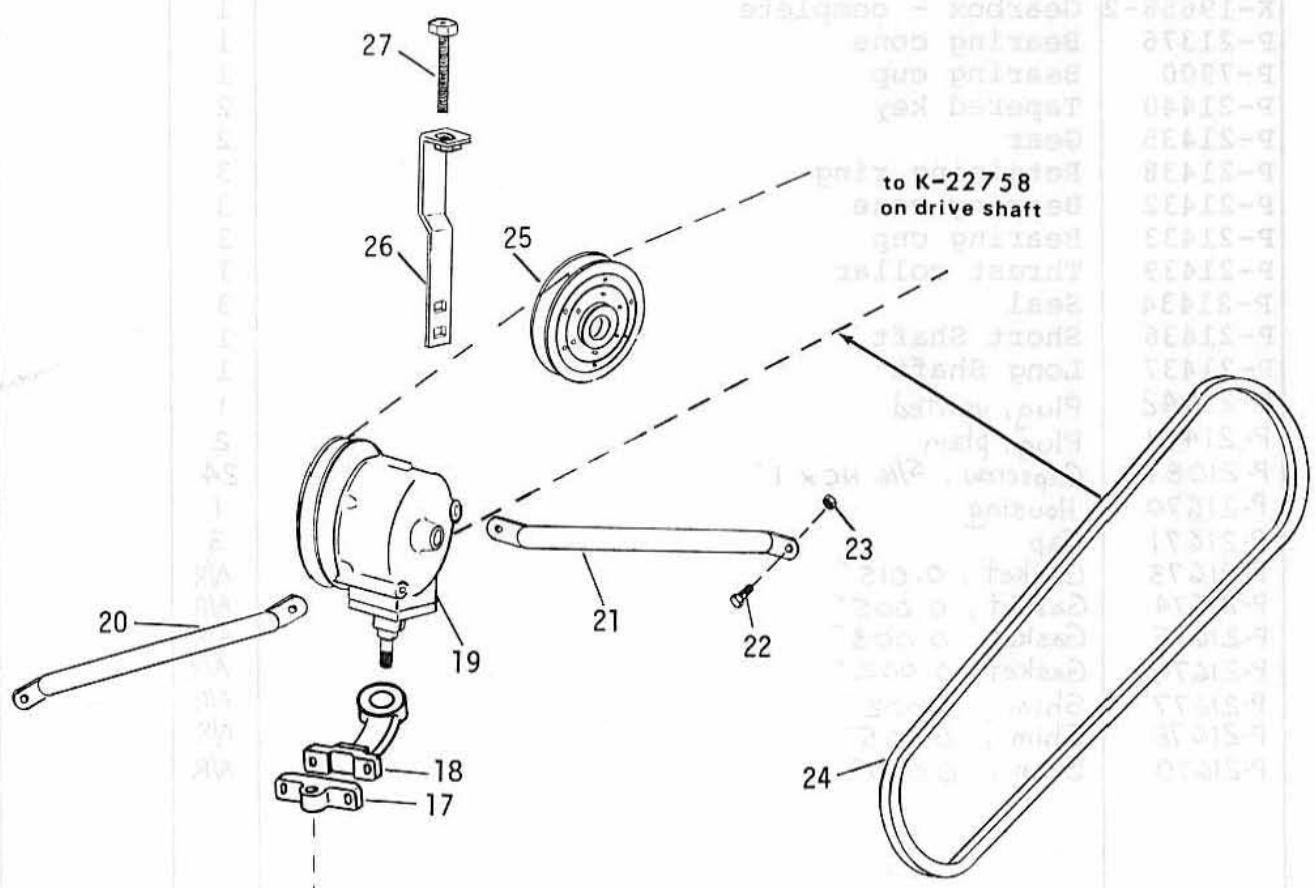

FRONT

REVISION 1, NOV. 78

KNIFE & KNIFE DRIVE

REF.	PART NO.	DESCRIPTION	QTY.	SERIAL NUMBER
1	K-19524-2	Over-serrated knife assy. c/w head (12 Ft. only) (includes items: 2,3,4,5,10,11,12,13)	1	
	K-19600-2	Over-serrated knife assy. c/w Head (14 Ft. only) (includes items 2,3,4,5,10,11,12,13)	1	
	K-19526-2	Over-serrated knife assy. less head (12. Ft. only) (includes items 2,3,4,10)	1	
	K-19601-2	Over-serrated knife assy. less head (14 Ft. only) (includes items 2,3,4,10)	1	
	K-23014-2	Smooth knife assy. c/w head (12 Ft. only) (includes items 2-A,3,4,5,10,11,12,13)	1	
	K-23015-2	Smooth knife assy. c/w head (14 Ft. only) (includes items 2-A,3,4,5,10,11,12,13)	1	
	K-23016-2	Smooth knife assy. less head (12 Ft. only) (includes items 2-A,3,4,10)	1	
	K-23017-2	Smooth knife assy. less head (14 Ft. only) (includes items 2-A,3,4,10)	1	
2	K-22268-1	Over-serrated knife section	12 Ft. 49 14 Ft. 57	
2-A	K-23009-1	Smooth Knife Section	12 Ft. 49 14 Ft. 57	
3	K-22266-1	L/H knife section	1	
4	K-22267-1	R/H knife section	1	
5	K-18253-1	Reinforcement	1	
6	K-8420-1	Guard 12 ft. only 14 ft. only	25 29	
7	K-7382-1	Knife support 12 ft. only 14 ft. only	11 13	
8	K-18170-1	Shim 12 ft. only 14 ft. only	11 13	
9	K-8216-1	Knife clip 12 ft. only 14 ft. only	11 13	
10	P-7258	Rivet .208 dia.x.63 long: 12 ft. only 14 ft. only	89 105	
11	P-21411	Rivet .208 dia.x.75 long	5	
12	P-18730	Rivet .208 dia.x 1.0 long	8	
13	K-18189-1	Knife head	1	
14	K-2337(-1)	Dust seal	1	
15	P-21416	Slotted nut .625 NF	1	
16	P-18605	Cotter pin .125 dia. x 1.0 long	1	
17	P-21414	Stud Holder	1	
18	P-21413	Drive arm	1	
19		See wobble box - complete page 10		
20	K-18134-1	Front pipe brace 19.53" long	1	
21	K-18135-1	Rear pipe brace 23.53" long	1	
22	P-21449	Flange bolt .50 NC x 1.0" long	4	
23	P-21383	Flange nut .50 NC	2	
24	K-9530-1	Belt	1	
25	P-21020	Idler pulley	1	
26	K-18868-1	Belt tightener	1	
27	K-18200-1	Tightener bolt	1	
28	K-22990-2	Stub Guard Kit: 12 Ft. only (includes items: 29,31,32,33,34,35)	1	
	K-22991-2	Stub Guard Kit: 14 Ft. only (includes items: 29,30,31,32,33,34,35) Note: Stub guard kits also include hardware and necessary quantities of K-7282-1:knife supports (ref. 7) to allow one per guard.	1	
29	K-22988-1	Cutter bar spacer - 28.25" long	5	
30	K-22989-1	Cutter bar spacer - 22.25" long: 14 Ft. only	1	
31	P-21662	Stub Guard	12 Ft. 25 14 Ft. 29	
32	P-21663	Hold Down Clip	12 Ft. 22 14 Ft. 26	
33	K-23021-1	Clip Retainer	12 Ft. 44 14 Ft. 52	
34	P-21664	Hi-Arc Hold Down Clip	3	
35	K-23022-1	Hi-Arc Clip Retainer	6	
36	K-23572-1	Reinforcement, Cutterbar	3	

WOBBLE BOX

WARRANT & KNIFE DRIVE

REF.	PART NO.	DESCRIPTION	QTY.	REMARKS
1	K-18198-1	Wobble Box	1	
2	K-18198-2	Wobble Box Cover	1	
3	K-18198-3	Wobble Box Gasket	1	
4	K-18198-4	Wobble Box Seal	1	
5	K-18198-5	Wobble Box Bolt	1	
6	K-18198-6	Wobble Box Nut	1	
7	K-18198-7	Wobble Box Washer	1	
8	K-18198-8	Wobble Box Flange	1	
9	K-18198-9	Wobble Box Pin	1	
10	K-18198-10	Wobble Box Ring	1	
11	K-18198-11	Wobble Box Bracket	1	
12	K-18198-12	Wobble Box Nut	2	
13	K-18198-13	Wobble Box Washer	2	
14	K-18198-14	Wobble Box Ring	1	
15	K-18198-15	Wobble Box Bolt	1	
16	K-18198-16	Wobble Box Nut	1	
17	K-18198-17	Wobble Box Washer	1	
18	K-18198-18	Wobble Box Bolt	1	
19	K-18198-19	Wobble Box Nut	1	
20	K-18198-20	Wobble Box Ring	1	
21	K-18198-21	Wobble Box Ring	1	
22	K-18198-22	Wobble Box Assembly	1	
23	K-18198-23	Wobble Box Bolt	1	
24	K-18198-24	Wobble Box Nut	1	
25	K-18198-25	Wobble Box Washer	1	
26	K-18198-26	Wobble Box Bolt	1	
27	K-18198-27	Wobble Box Nut	1	
28	K-18198-28	Wobble Box Bolt	1	not included in K-18198
29	K-18198-29	Wobble Box Nut	1	
30	K-18198-30	Wobble Box Washer	1	
31	K-18198-31	Wobble Box Bolt	1	
32	K-18198-32	Wobble Box Nut	1	

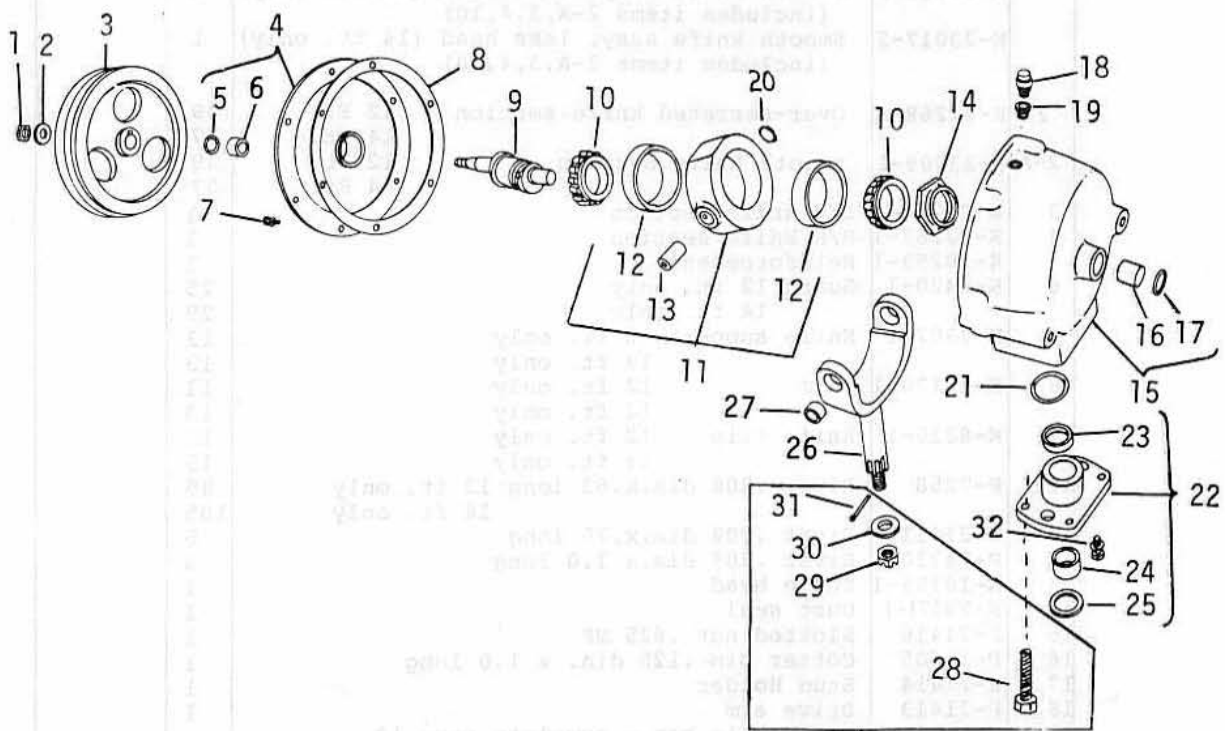

not included in K-18198

WOBBLE BOX

REF.	PART NO.	DESCRIPTION	QTY.	SERIAL NUMBER
	K-18198-2	Wobble box - complete (excludes items 28-31)	1	
1	P-18689	Lock nut .75 NC	1	
2	P-21417	Washer .78 I.D. x 1.63 O.D. x .18 Thk.	1	
3	P-21418	Driven Sheave	1	
4	P-21421	Cover (includes items 5 & 6)	1	
5	P-21419	Oil Seal	1	
6	P-21420	Bearing	1	
7	P-21520	Capscrew .31 NC x 1.0 long	6	
8	P-21422	Gasket	1	
9	P-21712	Wobble shaft	1	
10	P-21512	Bearing cone	2	
11	P-21714	Wobble joint housing (includes item 12	1	
12	P-21519	Bearing cup	2	
13	P-21713	Spindle	2	
14	P-21424	Stake Nut	1	
15	P-21427	Drive case (includes items 16 & 17)	1	
16	P-21513	Bearing	1	
17	P-21426	Oil seal	1	
18	P-21425	Relief valve	1	
19	P-21024	Reducer bushing .375 NPT x .125 NPT	1	
20	P-21716	Plug, plastic	2	
21	P-21514	O ring	1	
22	P-21428	Cap c/w bearings (includes items 23, 24 & 25)	1	
23	P-21515	Inner bearing	1	
24	P-21516	Outer bearing	1	
25	P-21517	Oil Seal	1	
26	P-21429	Yoke c/w bushing	1	
27	P-21715	Bushing	2	
28	K-21541-1	Special bolt	4	
29	P-5440	Slotted nut .75 NC	1	
30	K-21717-1	Washer .78 I.D. x 2.0 O.D. x .25 Thk.	1	
31	P-18648	Cotter pin .19 dia. x 1.25 long	1	
32	P-21522	Mounting screw .4375 NC x 1.0 long Gr. 5	2	

AUGER & AUGER DRIVE

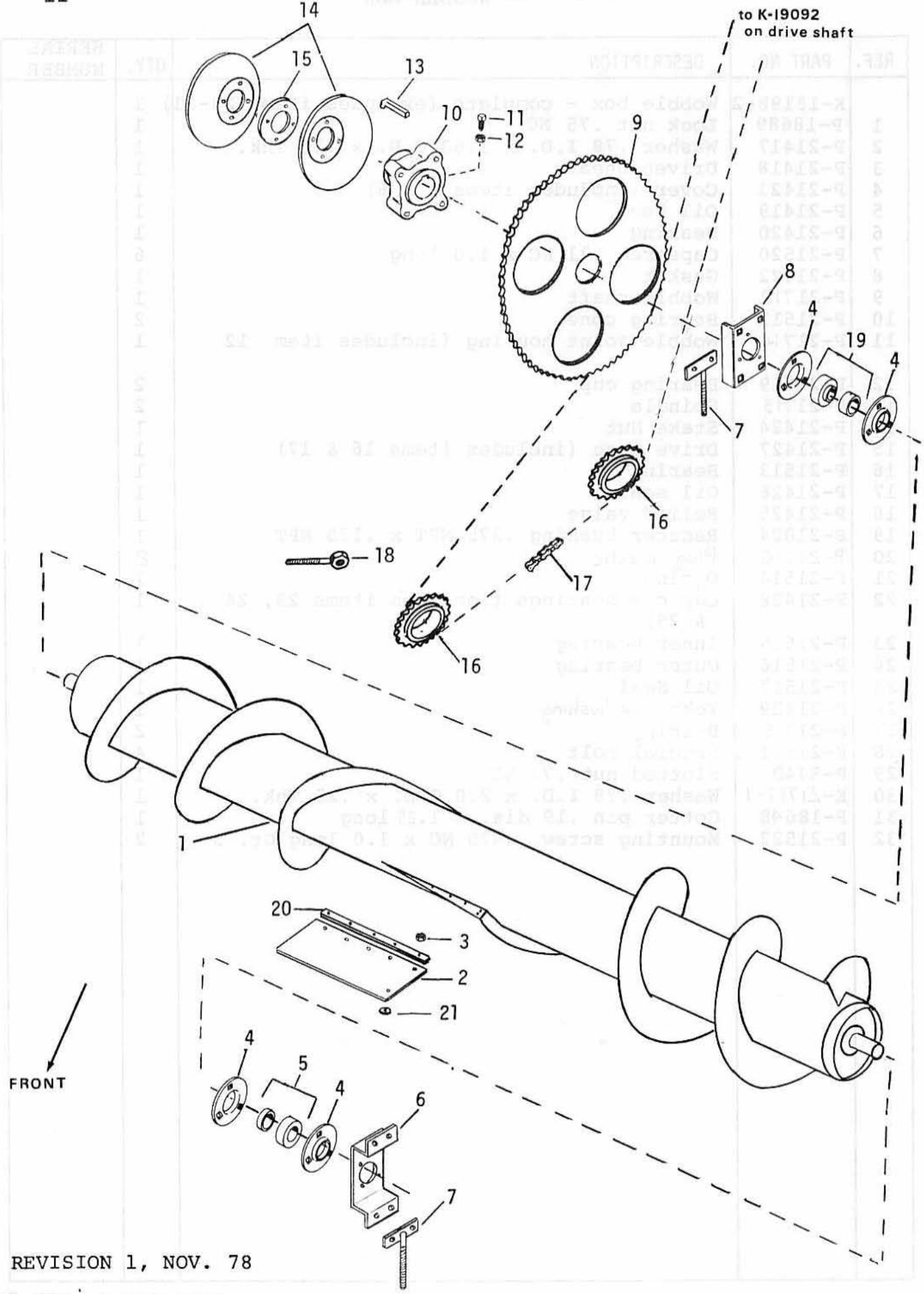

REVISION 1, NOV. 78

REVISION 1, NOV. 78

AUGER & AUGER DRIVE

REF.	PART NO.	DESCRIPTION	QTY.	SERIAL NUMBER
1	K-19101-1	Auger 12 ft. only	1	
	K-18376-1	Auger 14 ft. only	1	
2	K-22870-1	Rubber flapper	2	
3	P-18690	Locknut .31 NC.	12	
4	P-21699	3-hole flangette	4	
5	P-7490	Bearing c/w locking collar	1	
6	K-20573-1	L/H auger mount	1	
7	K-19245-1	Adjuster	2	
8	K-18193-1	R/H Auger Mount	1	
9	K-19670-1	Sprocket	1	
10	K-19793-1	Auger Drive Hub	1	
11	P-21293	Cup point setscrew .375 NC x 1.25 long	1	
12	P-18664	Jam nut .375 NC	1	
13	P-21298	Sq. gib headed key .31 x .31 x 2.0 long	1	
14	K-19598-1	Pulley half	2	
15	K-19255-1	Pulley shim	5	
16	P-8124	Idler Sprocket	2	
17	P-21107	Roller chain RC 50 x 122 links c/w connector	1	
18	K-20571-1	Adjuster bolt	1	
19	P-21288	Bearing c/w locking collar	1	
20	K-22999-1	Flapper Bar	2	
21	K-14799-1	Washer	2	

REEL & REEL DRIVE

13

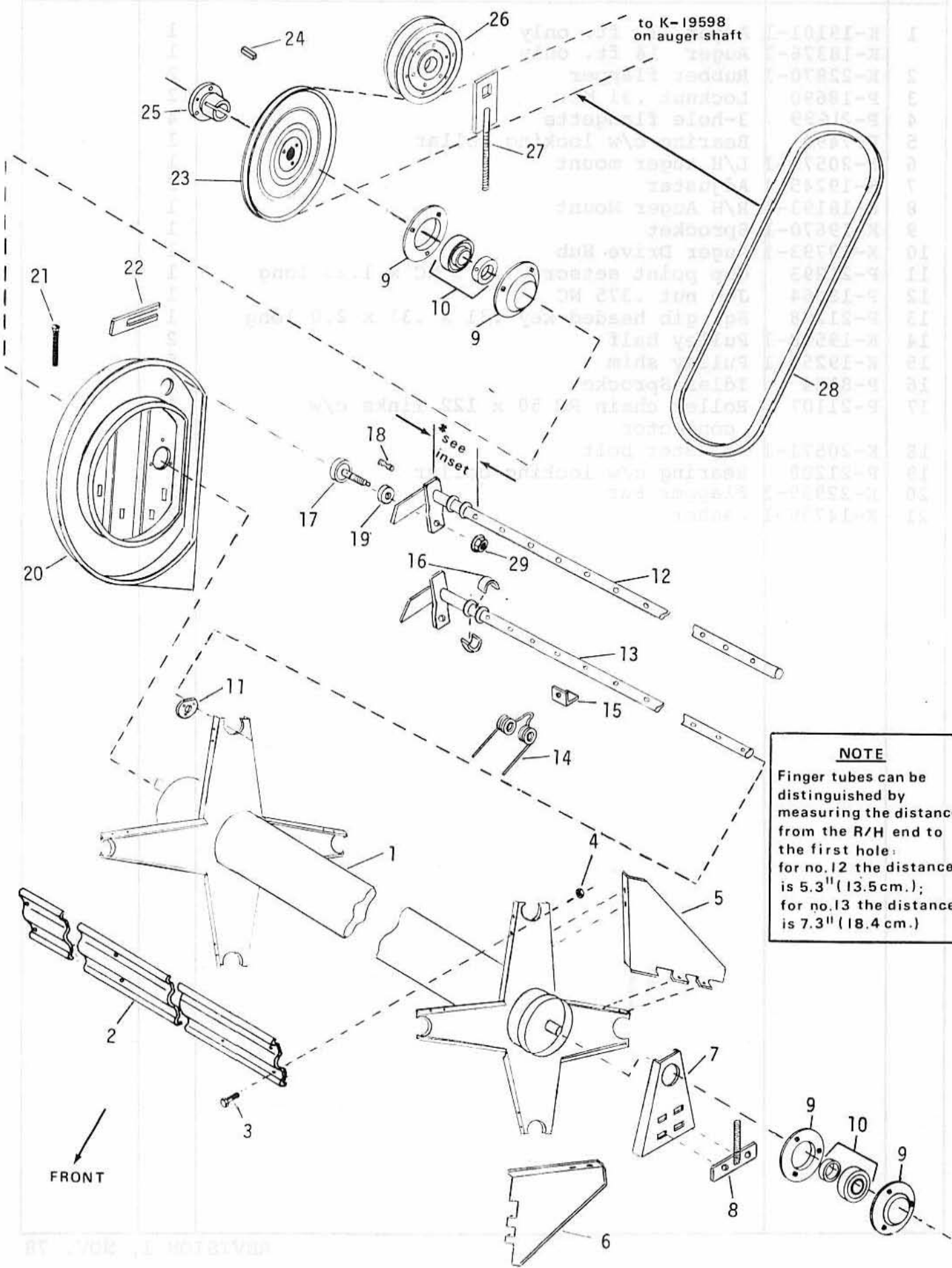

RT VOE MOT BTVIDP

REEL & REEL DRIVE

REF.	PART NO.	DESCRIPTION	QTY.	SERIAL NUMBER
1	K-19181-1	Reel tube 12 ft. only	1	
	K-19241-1	Reel tube 14 ft. only	1	
2	K-19213-1	Reel bat 12 ft. only	4	
	K-18208-1	Reel bat 14 ft. only	4	
3	P-30278	Flange head lock screw .31 NC x long Gr.5 12 ft. only	32	
		14 ft. only	40	
4	P-21403	Flange nut .31 NC 12 ft. only	32	
		14 ft. only	40	
5	K-22872-1	R/H shield	2	
6	K-22873-1	L/H shield	2	
7	K-22547-1	L/H reel support weld't.	1	
8	K-18206-1	Reel height adjuster	1	
9	P-21699	3 hole flangette	4	
10	P-7490	Bearing c/w locking collar	2	
11	K-1090-1	Flangette 12 ft. only	24	
		14 ft. only	32	
12	K-19469-1	Finger tube 12 ft. only (see note below)	2	
	K-19215-1	Finger tube 14 ft. only (see note below)	2	
13	K-19467-1	Finger tube 12 ft. only (see note below)	2	
	K-19186-1	Finger tube 14 ft. only (see note below)	2	
		Note: When ordering finger tubes, be sure you have properly identified the required tube by following the measurement instructions given in the inset on page 13		
14	K-20607-1	4 coil double pick-up finger 12 ft. only	68	
		14 ft. only	80	
15	K-19183-1	Tooth clip 12 ft. only	68	
		14 ft. only	80	
16	K-28038-1	Reel arm bearing (includes 2 halves): 12 ft.	12	
		14 ft.	16	
17	K-20565-1	Cam follower c/w grease fitting	4	
	P-21661	Cam follower w/o grease fitting	A/R	
18	P-21299	Replacement grease fitting	A/R	
19	K-18209-1	Spacer	4	
20	K-19509-1	Cam track	1	
21	P-21143	Capscrew .375 NC x 3.5 long (reel height adjustment) - thread full length	2	
22	K-16837-1	Shim	A/R	
23	K-20566-1	Reel drive pulley	1	
24	K-7038-1	Key .25 x .25 x 2.0 long	1	
25	P-21047	Split taper bushing c/w bolts & key	1	
26	P-21020	Idler pulley	1	
27	K-19528-1	Belt tightener	1	
28	K-20568-1	Belt (Alternate: K-28030-1)	1	
29	P-21550	Flange lock nut .625 NF	4	
		Alternate: To P-21550 is one P-21667, ext. tooth lockwasher and one P-21668, .625 NF hex nut in combination.		

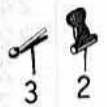
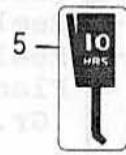
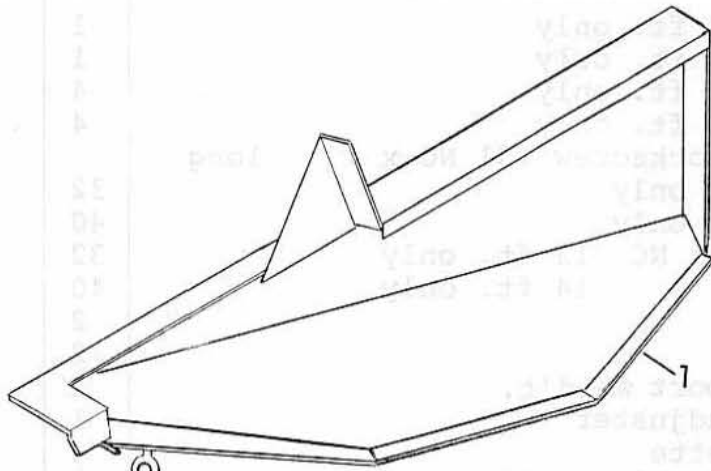

WARNING
SHUT OFF ENGINE
BEFORE OPENING COVER

WARNING
BE SURE HEADER AND REEL
ARE PROPERLY BLOCKED WHEN
SERVICING OR ADJUSTING
IN RAISED POSITION

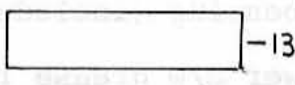

JACK HERE ↑

CAUTION
SHUT ENGINE OFF BEFORE MAKING ANY
HEADER OR REEL ADJUSTMENTS

NO LIFT OR TIE

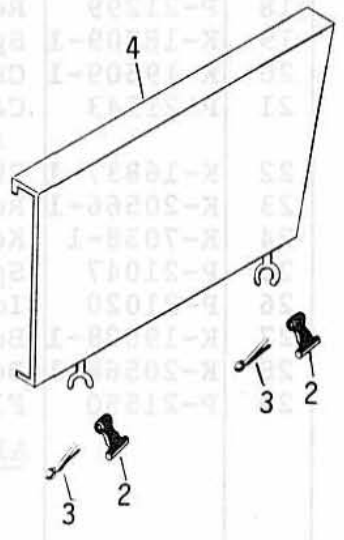

REF.	PART NO.	DESCRIPTION	QTY.	SERIAL NUMBER
1	K-18384-1	R/H end shield	1	
2	P-21021	Rubber hood latch	3	
3	P-18609	Cotter pin .25 dia. x 2" long	3	
4	K-18397-1	L/H knife drive shield	1	
5	K-23163-1	10 Hr. greasing decal	2	
6	K-23165-1	50 Hr. greasing decal	4	
7	K-23283-1	"Warning" decal	2	
8	K-23295-1	"Jack Here" decal	2	
9	K-23510-1	"Warning" decal	1	
10	P-18684	Red reflector tape 2" x 8"	2	
11	K-23285-1	"Caution" decal	2	
12	K-23292-1	"No lift or tie" decal	2	
13	P-20016	Amber reflector tape 2" x 8"	1	

HAY CONDITIONER FRAME & SHIELDS

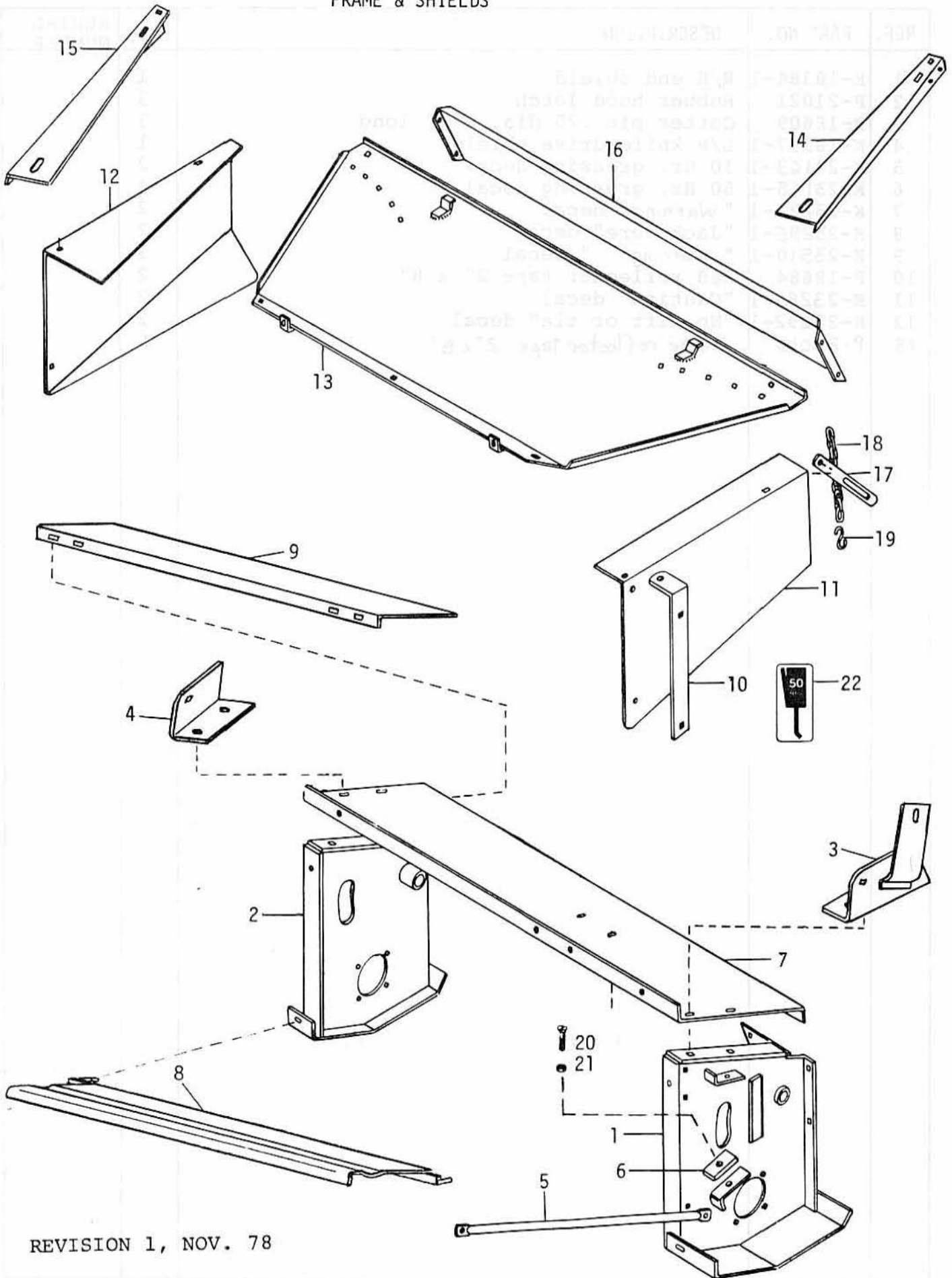

HAY CONDITIONER FRAME & SHIELDS

REF.	PART NO.	DESCRIPTION	QTY.	SERIAL NUMBER
1	K-22338-2	L/H end weldt. c/w rubber bushing	1	-52643
	K-22997-2	L/H end weldt. c/w rubber bushing	1	52644-
2	K-22339-2	R/H end weldt. c/w rubber bushing	1	-52643
	K-22998-2	R/H end weldt. c/w rubber bushing	1	52644-
3	K-22816-1	L/H support mount weldt.	1	
4	K-18307-1	R/H mount	1	
5	K-19168-1	Support pipe	2	
6	K-19109-1	Rubber bumper	4	
7	K-22344-1	Top sheet	1	
8	K-19553-1	Feeder Plate	1	
9	K-22867-1	Deflector	1	
10	K-19163-1	Front Mounting Bracket	2	
11	K-19172-1	L/H forming shield	1	
12	K-20127-1	R/H forming shield	1	
13		Tractor bottom shield (see self-propelled swather parts book)		
14	K-22798-1	L/H support angle	1	
15	K-22799-1	R/H support angle	1	
16	K-17765-1	Fluffing Shield	1	
17	K-17766-1	Adjustment bracket	2	
18	P-21291	Chain	2	
19	P-21292	"S" Hook	2	
20	P-21302	Flat Hd. slotted capscrew .31 NC x 1.25 long	4	
21	P-7271	Locknut .31 NC	4	
22	K-23165-1	Greasing decal - 50 Hrs.	2	

HAY CONDITIONER DRIVE

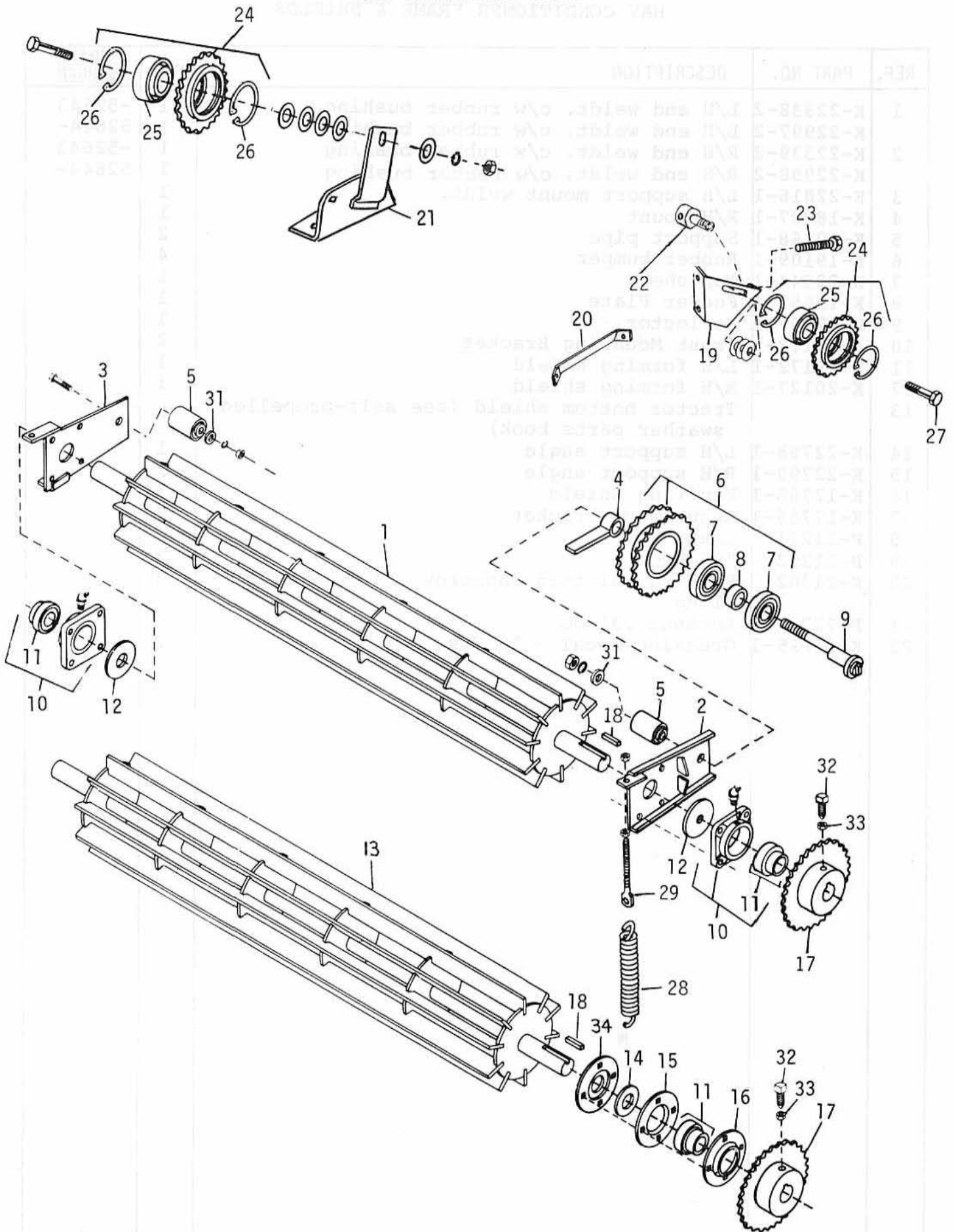

HAY CONDITIONER DRIVE

20

REF.	PART NO.	DESCRIPTION	QTY.	SERIAL NUMBER
1	K-10102-1	Crimping roller - Upper	1	
2	K-19104-1	L/H pivot arm	1	
3	K-19103-1	R/H pivot arm	1	
4	K-19091-1	Pivot brace	1	
5	P-13626	Rubber bushing	2	
6	K-20108-2	Double sprocket c/w bearings & spacers	1	
7	P-21310	Ball bearing	2	
8	K-19106-1	Spacer - 1.04 I.D. x 1.31 O.D. x .71 long	1	
9	K-19052-1	Eccentric pin	1	
10	P-30052	Flange block c/w bearing	2	
11	P-30031	Ball bearing c/w collar	4	
12	K-19249-1	Felt Seal	2	-52643
13	K-23469-1	Crimping Roller - Lower	1	
14	K-19057-1	Felt seal	2	-52643
15	P-21703	Flangette	2	
16	P-21706	Regreasable flangette	2	
17	K-19102-1	Sprocket	2	
18	K-17165-1	Tapered key	2	
19	K-20284-1	Idler mount	1	
20	K-22308-1	Idler mount support	1	
21		L/H support mount (see page 18)		
22	K-16428-1	Special idler bolt	1	
23	P-21143	Hex. Bolt .375 NC x 3.5 long thread full length	1	
24	K-9333-2	Idler sprocket assy. c/w bearing	2	
25	P-9213	Ball bearing	2	
26	P-795	Snap ring	4	
27	P-21447	Flange head capscrew .375 NC x 1.0 long	1	
28	K-9423-1	Spring	2	
29	K-19119-1	Eye bolt	2	
30				
31	K-22072-1	Washer .66 I.D. x 1.50 O.D. x .19 Thk.	2	
32	P-21293	Sq. Hd. Cup Pt. setscrew .375 NC x 1.25 long	4	
33	P-18664	Jam nut .375 NC.	4	
34	K-18557-1	Seal Flange	2	-52643
	K-23467-1	Seal Flange	2	52644-

REVISION 1, NOV. 78

HAY CONDITIONER
CHAINS

REF.	PART NO.	DESCRIPTION	QTY.	SERIAL NUMBER
1	P-21064	No. 60 chain x 42 links c/w connector	1	
2	P-21101	No. 60 chain x 126 links c/w connector	1	
	P-21605	No. 60 Cottered Connecting Link	A/R	

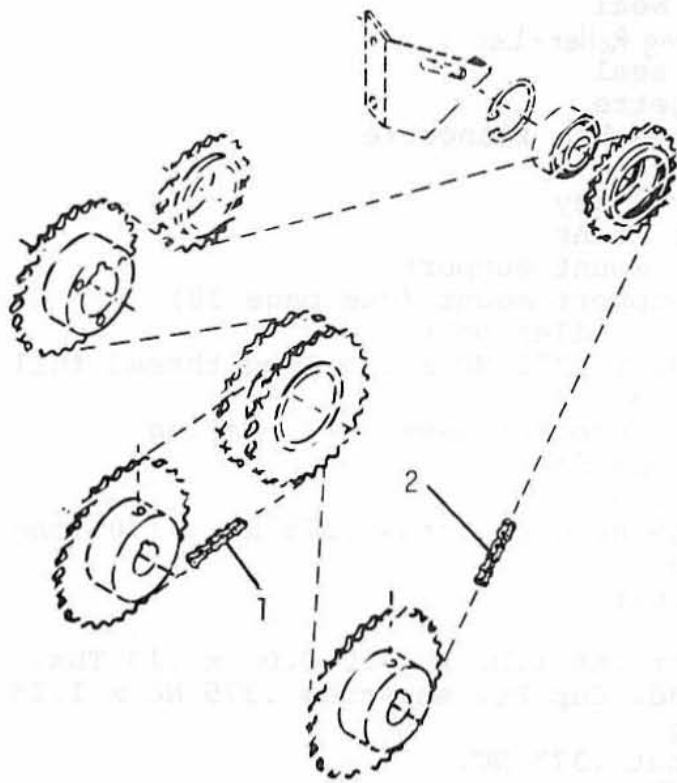

NUMERICAL LIST

PART NUMBER	PAGE	PART NUMBER	PAGE
P-795	20	K-18190-1	4
K-1090-1	14	K-18192-1	2
P-2149	4	K-18193-1	12
		K-18198-2	10
		K-18200-1	8
P-5440	10	K-18206-1	14
K-7038-1	4, 14	K-18208-1	14
P-7258	8	K-18209-1	14
P-7271	18	K-18253-1	8
		K-18307-1	18
K-7295-1	4	K-18376-1	12
K-7382-1	8	K-18384-1	16
P-7490	12, 14	K-18397-1	16
P-7900	6		
P-8124	12	K-18472-1	2
K-8216-1	8	K-18485-1	2
K-8420-1	8	P-18534	4
		K-18557-1	20
P-9213	20	P-18605	8
K-9333-2	20	P-18609	16
K-9423-1	20	P-18648	10
K-9530-1	8	P-18664	4, 12, 20
K-10102-1	20	P-18684	16
P-13298	4	P-18689	10
		P-18690	12
P-13626	20	P-18730	8
K-14799-1	12	K-18868-1	8
K-16428-1	20	P-18908	4
K-16837-1	14	K-18909-1	4
K-17165-1	20	P-18919	4
K-17765-1	18		
K-17766-1	18	P-18922	4
K-18134-1	8	K-19052-1	20
K-18135-1	8	K-19057-1	20
K-18170-1	8		
K-18189-1	8	K-19087-1	2

PART NUMBER	PAGE	PART NUMBER	PAGE
K-19091-1	20	K-19528-1	14
K-19092-2	4	K-19553-1	18
K-19101-1	12	K-19598-1	12
K-19102-1	20	K-19600-2	8
K-19103-1	20	K-19601-2	8
		K-19658-2	6
K-19104-1	20	K-19660-1	12
K-19106-1	20	K-19680-1	2
K-19109-1	18	K-19751-2	4
K-19117-1	4	K-19793-1	12
K-19119-1	20	P-20016	16
		K-20108-2	20
K-19130-1	2	K-20127-1	18
K-19163-1	18	K-20284-1	20
K-19168-1	18	P-20504	4
K-19172-1	18	K-20565-1	14
K-19181-1	14	K-20566-1	14
K-19183-1	14	K-20568-1	14
K-19186-1	14	K-20571-1	12
K-19187-2	2	K-20573-1	12
K-19188-2	2	K-20607-1	14
K-19213-1	14	P-21020	8,14
K-19215-1	14	P-21021	16
K-19228-1	2	P-21024	10
		P-21047	14
K-19241-1	14		
K-19244-1	2	P-21057	4
K-19245-1	12	P-21064	21
K-19249-1	20	P-21087	6
K-19255-1	12	P-21101	21
K-19467-1	14	P-21107	12
K-19469-1	14	P-21143	14,20
		P-21151	10
K-19471-1	4	P-21156	4
K-19482-1	4	P-21210	4
K-19483-1	4	P-21214	4
K-19509-1	14	P-21246	4
K-19524-2	8	P-21288	12
K-19526-2	8		